

KS Series

Tact Switches(Illuminated)



SPECIFICATIONS
RATING : 100mA max, 42 VAC/DC
MECHANICAL LIFE : 1,000,000 cycles
CONTACT RESISTANCE : 100mΩ max.(initial)
INSULATION RESISTANCE : 1000MΩ min.
DIELECTRIC STRENGTH : 1,000 VAC
FORCE : 3N±0.75N
TRAVEL : 0.6±0.2mm
OPERATING TEMPERATURE RANG : -25°C~+70°C

MATERIALS
SWITCH HOUSING : PBT
TRANSPARENT ACTUATOR : PC
ACTUATOR : ABS
CONTACT : Stainless,Au or Ag plated
TERMINALS : Brass,Au or Ag plated
TERMINAL SEAL : Epoxy



HOW TO ORDER

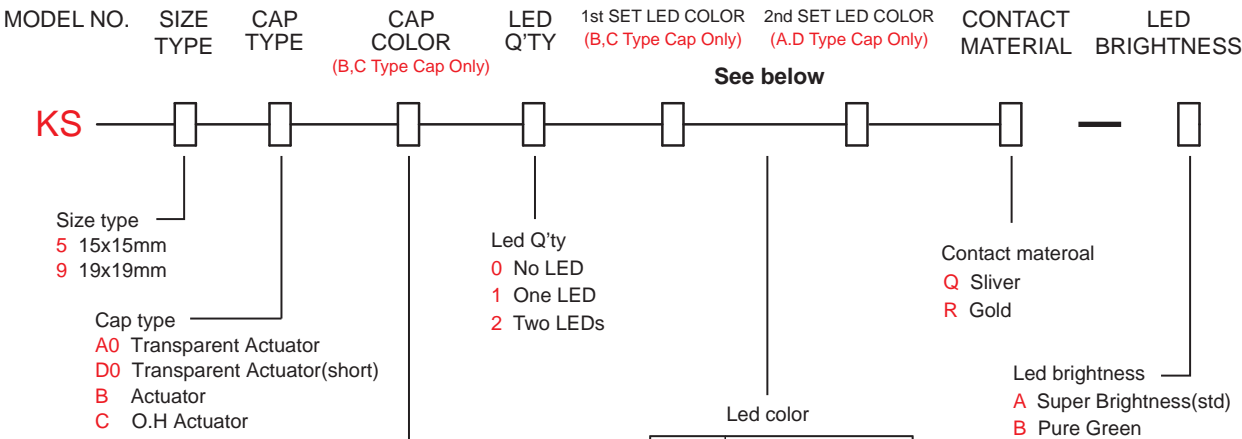

ITEM NO	COLOR
1	White (Std)
3	Red (Std)
4	Orange
5	Yellow
6	Green
7	Blue

* Besides standard color, other colors need to check stocks available.

ITEM NO	COLOR
0	Without LED
1	White
3	Red
5	Yellow
6	Green
7	Blue
DUAL COLOR LED	
A	Red&Pure Green
B	Yellow&Pure Green

EXAMPLE:
KS5A0000R (Without LED)
KS5A020 [] R-A
 |
 LED color
KS5B [] 2 [] 0R-A
 | |
 LED color
 CAP color

P.C.B MOUNTING / CIRCUIT

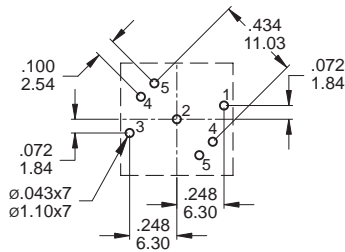

KS5A CAP Type
TOP VIEW

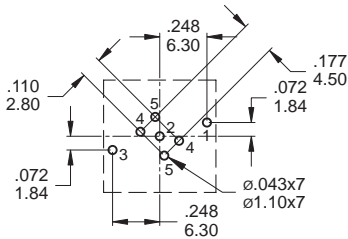

KS5B/C CAP Type
TOP VIEW

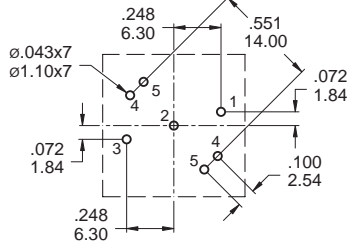

KS9A CAP Type
TOP VIEW

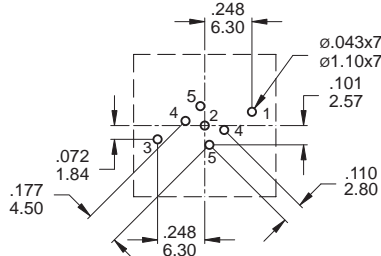

KS9B/C CAP Type
TOP VIEW

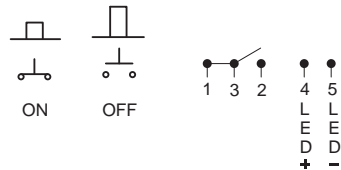

CIRCUIT

KS5A0

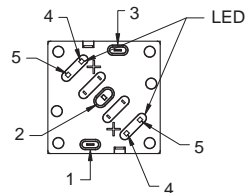
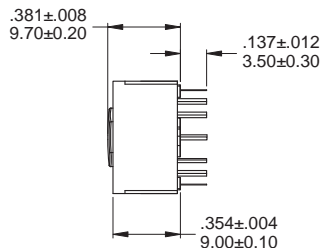
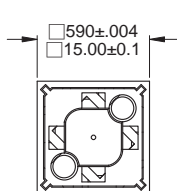

KS5D0

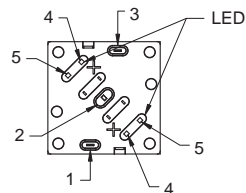
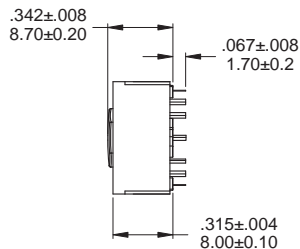
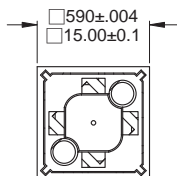

KS5B

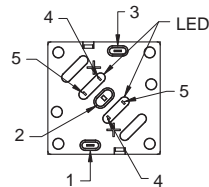
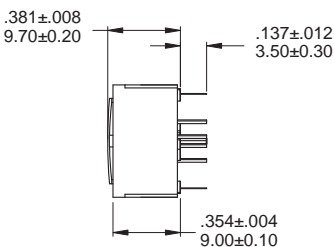
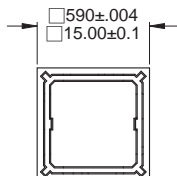

KS Series

Tact Switches(Illuminated)

KS5C

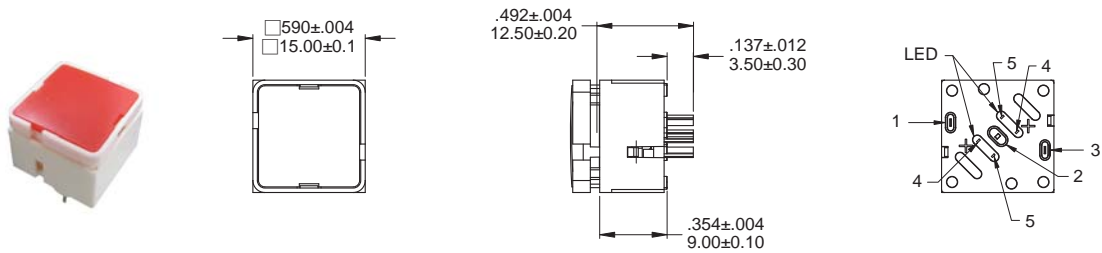

KS9A

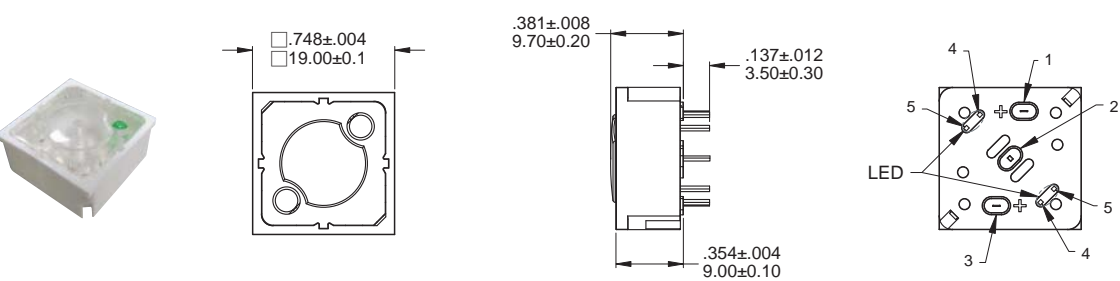

KS9B

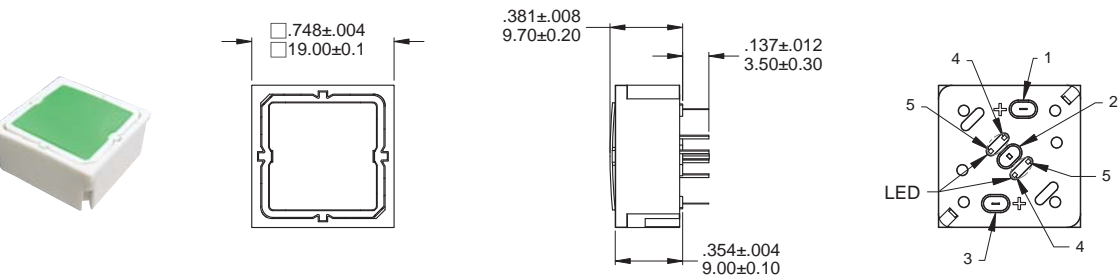

KS9C

