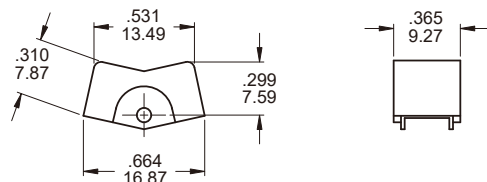
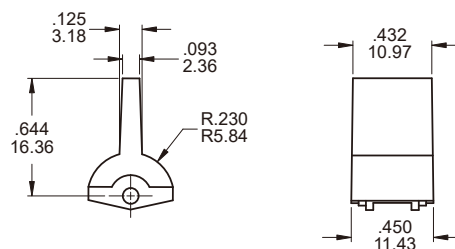
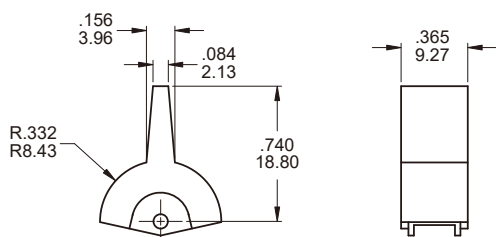
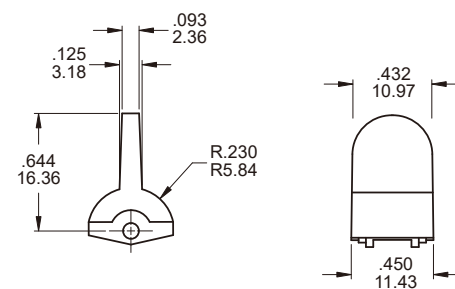
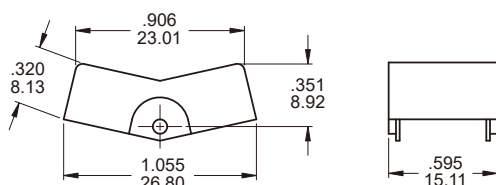
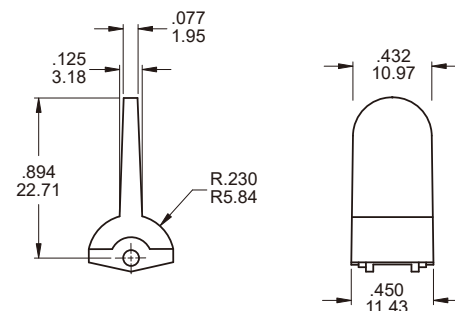
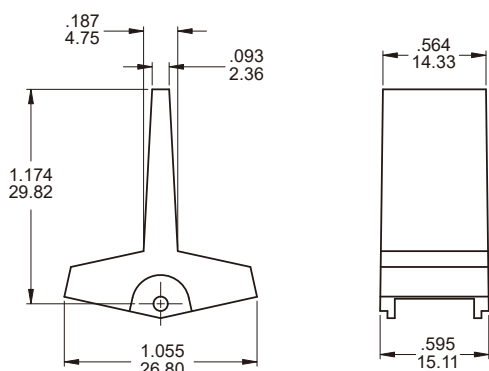
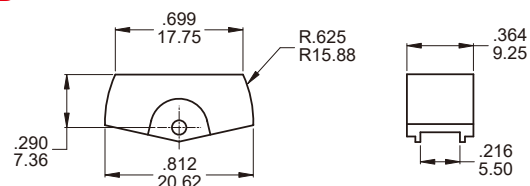
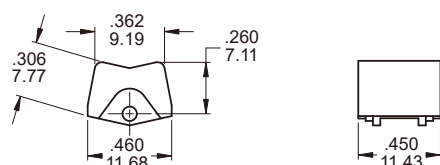
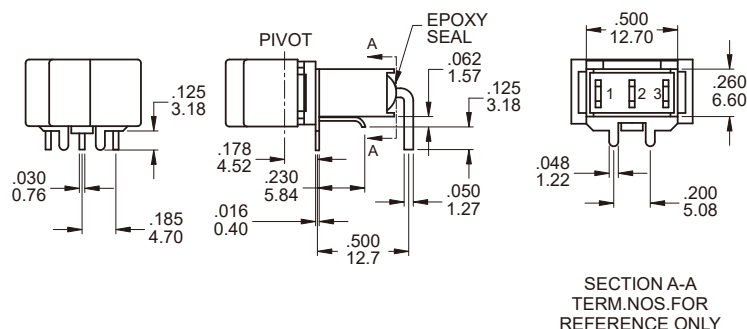
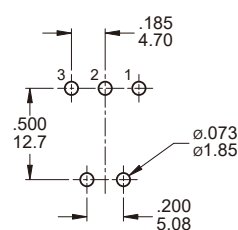

ACTUATOR OPTIONS FOR P.C. MOUNT ONLY
J1

J6

J2

J7

J3

J8

J4

JB

J5

Actuator colors:

ITEM NO	COLOR
1	White
2	Black (Std)
3	Red
4	Orange
5	Yellow
6	Green
7	Blue
8	Brown
9	Gray

* Besides standard color, other colors need to check stocks available.

M6

P.C. MOUNTING

SECTION A-A
TERM.NOS.FOR
REFERENCE ONLY

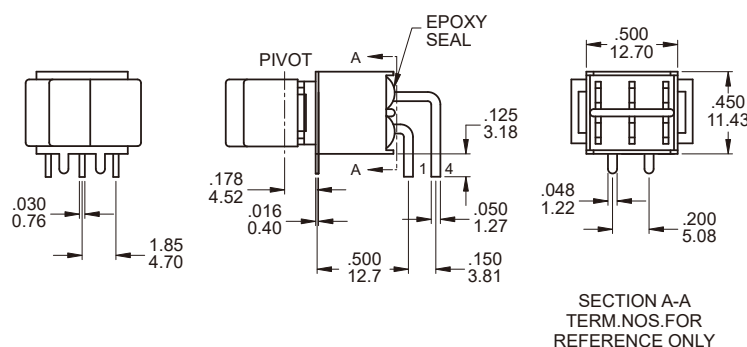
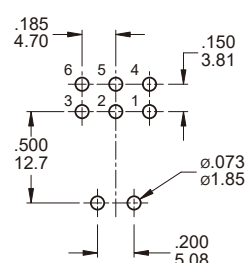
SPDT

Part No. Shown : 3AS1J102M6QES

M6

P.C. MOUNTING

SECTION A-A
TERM.NOS.FOR
REFERENCE ONLY

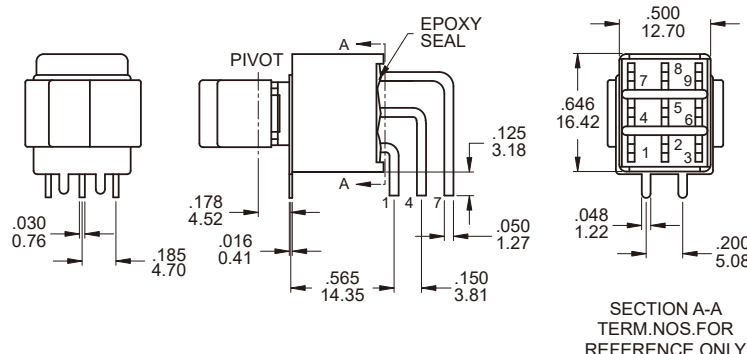
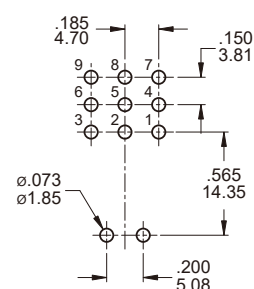
DPDT

Part No. Shown : 3AD1J102M6QES

M6

P.C. MOUNTING

SECTION A-A
TERM.NOS.FOR
REFERENCE ONLY

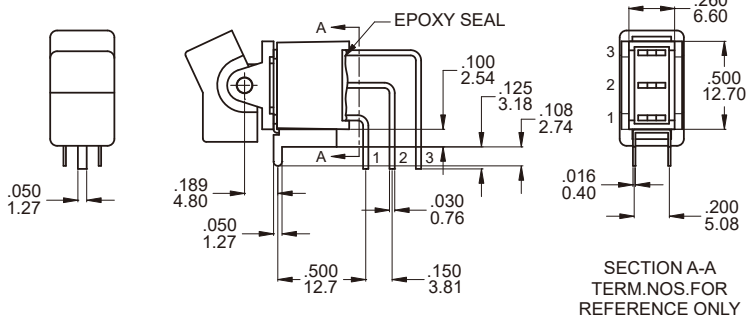
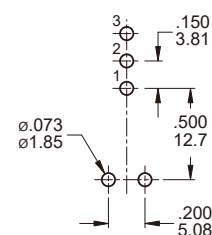
3PDT

Part No. Shown : 3A31J102M6RES

M7

P.C. MOUNTING

SECTION A-A
TERM.NOS.FOR
REFERENCE ONLY

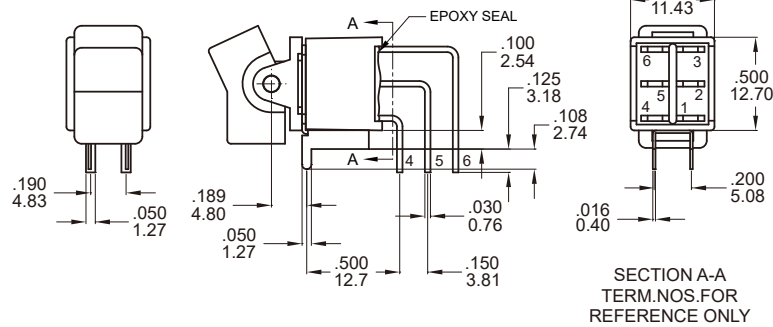
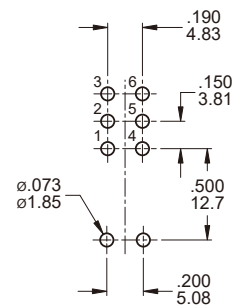
SPDT

Part No. Shown : 3AS1J102M7RES

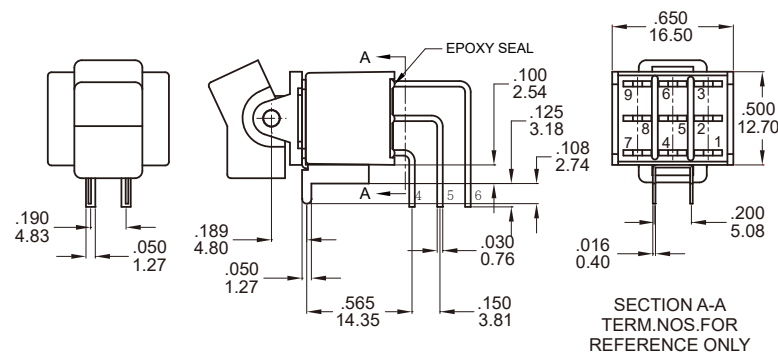
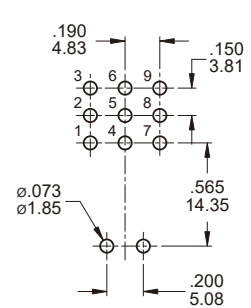
M7

P.C. MOUNTING

DPDT

Part No. Shown : 3AD1J102M7RES

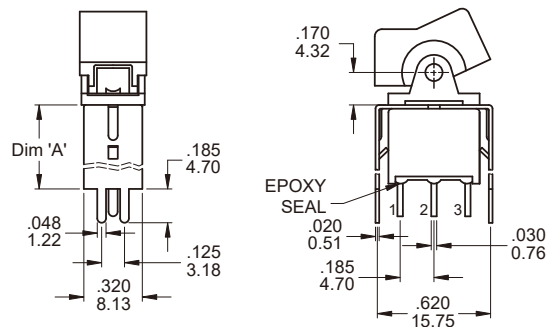
M7

P.C. MOUNTING

3PDT

Part No. Shown : 3A31J102M7RES

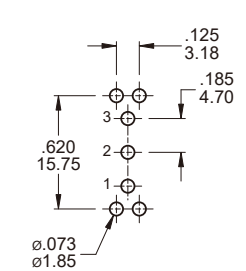
VS2 - VS3

OPTION CODE	DIM. 'A'
VS2	.460 11.68
VS3	.630 16.00

P.C. MOUNTING

SPDT

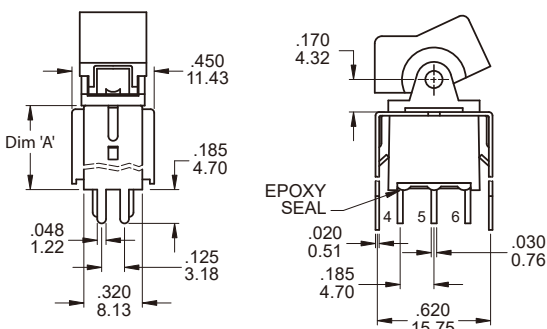
Part No. Shown : 3AS1J102VS2QES

VS2 - VS3

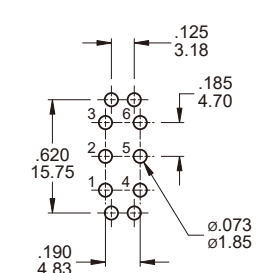
OPTION CODE	DIM. 'A'
VS2	.460 11.68
VS3	.630 16.00

P.C. MOUNTING

DPDT

Part No. Shown : 3AD1J102VS2QES

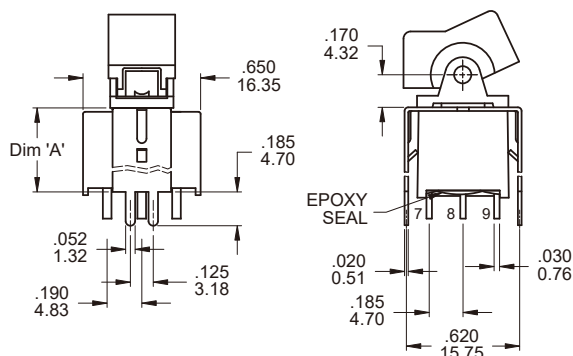

VS2 - VS3



OPTION CODE	DIM. 'A'
VS2	.460 11.68
VS3	.630 16.00

P.C. MOUNTING

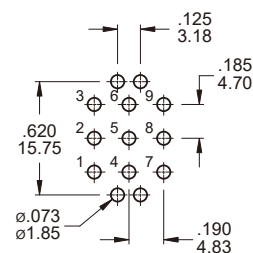

3PDT

Part No. Shown : 3A31J102VS2RES

SNAP-IN TERMINATION OPTIONS

M6N

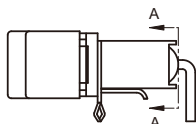

SECTION A-A

V2N

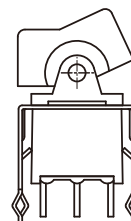
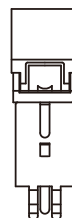

CONTACT MATERIAL OPTIONS

	CONTACT PLATING	TERMINAL PLATING	RATINGS
Q	Silver	Gold flash over silver	5 Amps with resistant load @ 120VAC or 28VDC 2 Amps with resistant load @ 250VAC
C	Gold over Silver	Gold over silver	
R	Gold	Gold	0.4 Volt - Amps (VA) max. @ 20V max. (AC or DC)

SOLDERING PROCESSES

MANUAL SOLDERING: Use soldering iron of 30 watts, controlled at 350°C approximately 5 seconds while applying solder.

WAVE SOLDERING: Recommended Soldering Temperature: 270 ± 5°C

Duration of Solder Immersion: Max 5 sec. (PCB is 1.6mm in thickness)