

SECTION B-B

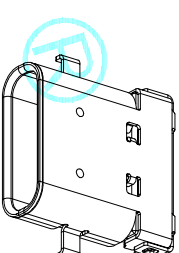
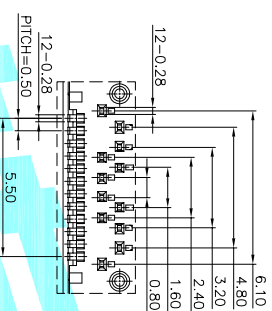
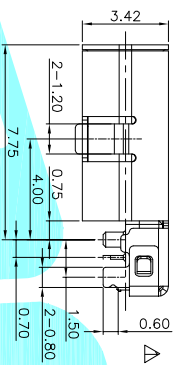
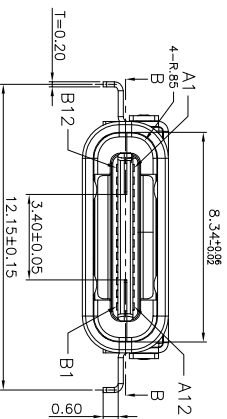

Detail A

NOTE:

1. MATERIAL:

1.1 INSULATOR: HIGH TEMPERATURE PLASTIC UL 94 V-0;

 $\vdash 0 = 1$

1.2 CONTACT: COPPER ALLOY (T=0.15mm)

1.3 SHELL: STAINLESS STEEL (T

2. ELECTRICAL CHARACTERISTICS:

2.1 CONTACT RESISTANCE: 40m Ω Max FOR INITIAL.

10m Ω CHANGE AFTER TEST. MEASURE AT 20mV, 100mA.

2.2 CONTACT CURR

1. 25A FOR VCON PIN.

2.3 DIELECTRIC WITHSTANDING VOLTAGE: 100V AC

24 INSULATION DISTANCE 100MM Min

2.5 OPERATING TEMPERATURE: $-40^{\circ}\text{C} \approx 85^{\circ}\text{C}$

3. MECHANICAL CHARACTERISTICS:

3.1 MATING FORCE: $5 \sim 20$ N.

3.2 UNMATED FORCE: 8~20N AFTER TEST

3.3 DURABILITY: 10,000 CYCLES

4. PLATING

4.1 TERMINAL CONTACT: (SEE TAB) GOLD PLATING ALL

OVER 50u" Min NICKEL AND :

Min NICKEL ON SOLDER AREA

| Pin | Signal Name | Mating Sequence | Pin | Signal Name | Mating Sequence |
|-------|------------------|-----------------|-------|------------------|-----------------|
| A1 | GND | First | B12 | GND | First |
| A2 | SS1Xp1 | Second | B11 | SSRXp1 | Second |
| A3 | SS1Xn1 | Second | B10 | SSRXn1 | Second |
| A4 | V _{BUS} | First | B9 | V _{BUS} | First |
| A5 | CC1 | Second | B8 | SB12 | Second |
| A6 | Dp1 | Second | B7 | Dn2 | Second |
| A7 | Dn1 | Second | B6 | Dp2 | Second |
| A8 | SBU1 | Second | B5 | CC2 | Second |
| A9 | V _{BUS} | First | B4 | V _{BUS} | First |
| A10 | SSRXn2 | Second | B3 | SS1Xn2 | Second |
| A11 | SSRXn2 | Second | B2 | SS1Xn2 | Second |
| A12 | GND | First | B1 | GND | First |
| SHELL | | GND | SHELL | | GND |

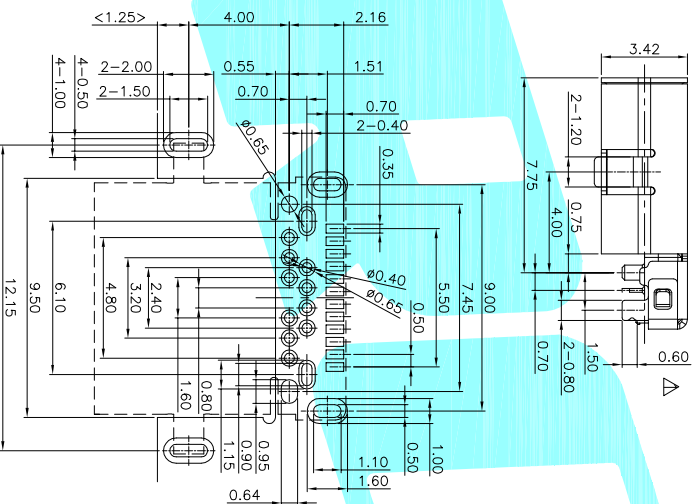
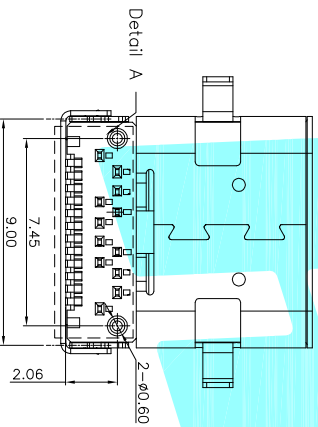

RECOMMEND P.C.B LAYOUT (COMPONENT SIDE)

TOLERANCE FOR PCB LAYOUT IS ± 0.05

Technical drawing of a PCB layout showing dimensions and a table of specifications.

Dimensions (mm):

- Overall width: 12.15
- Overall height: 9.50
- Inner width: 6.10
- Inner height: 4.80
- Top margin: 4-1.00
- Bottom margin: 4-0.50
- Left margin: 7.45
- Right margin: 9.00
- Bottom cutout width: 2.06

RECOMMEND P.C.B LAYOUT (COMPONENT SIDE)

TOLERANCE FOR PCB LAYOUT IS ± 0.05

KEEP OUT AREA

| ITEM | PART NAME | TER. NO. | QTY. | MATERIAL | FINISHING | REMARK |
|------|-----------|----------|------|-----------------|-----------|--------|
| ③ | Shell | — | 1 | STAINLESS STEEL | Ni Plated | — |
| ② | Contact | — | 24 | COPPER ALLOY | Au Plated | — |
| ① | Housing | — | 1 | LCP | Black | — |

| APPROVALS | | DATE | TITLE: USB CONNECTOR | | | |
|----------------|---------|-------------|----------------------|----------------|--|--|
| DRAWN | JKUN.LU | 2014.5.29 | ELECTRONICS CO., LTD | | | |
| CHECKED | | | | | | |
| APPROVALS | | | | | | |
| TOLERANCES ARE | | | PART NO. | TYPE-C-31-M-01 | | |
| 30~以上 | ±0.30 | ANGLE | | | | |
| 10~30 | ±0.25 | | | | | |
| 5~10 | ±0.20 | UNIT: mm | SCALE: 1:1 | | | |
| ~ 5 | ±0.15 | DRAWING NO. | SHEET 1 of 1 | | | |