

Circuit Diagram

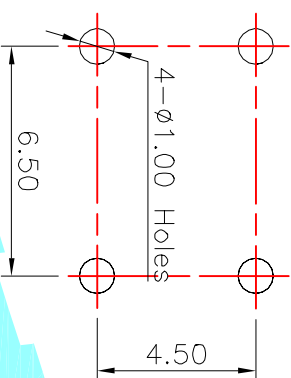

PCB Layout(Pattern side)

NO.1	
PART NO	H
A	4.3
C	5
G	7

NO.2	
PART NO	vigor
3	180±30
4	250±30

NO.3	
PART NO	MATERIAL/qty
S	SUS/1PC
C	CS210/1PC
D	SUS/2PCS
F	CS210/2PCS

NO.4-NO.5	
PART NO	NOTE
01~99	SERIAL NUMBER

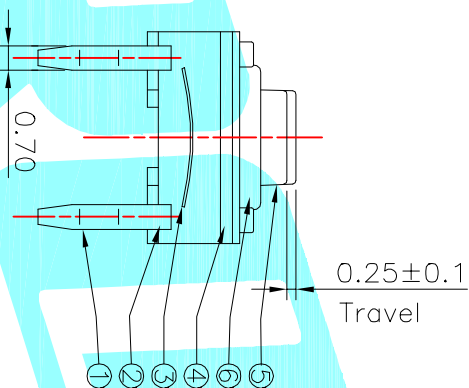
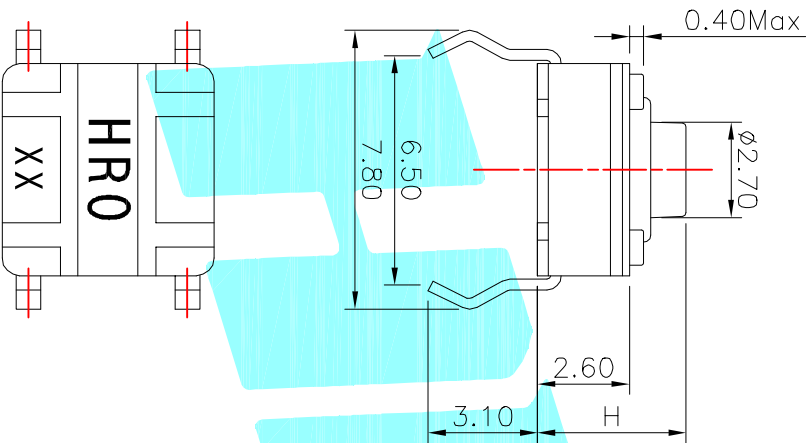

- Typical Specifications
- 1.Rating : DC 12V 50mA
 - 2.Contact Resistance: ≤100mΩ
 - 3.Insulation Resistance: ≥100mΩ DC250V
 - 4.Operating Temperature Range: -25℃+80℃
 - 5.Ambient Humidity Used: ≤85%RH
 - 6.Travel: 0.25±0.1mm
 - 7.Life : 500,000 Cycles
 - 8.IP Rating: IP66

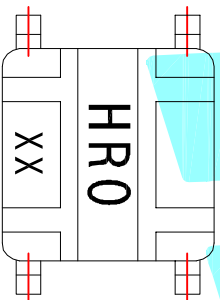

ITEM	PART NAME	TER'NO.	QTY.	MATERIAL	FINISHING	REMARK
⑥	Cover	—	1	Brass	Tin Plated	—
⑤	Keystroke	—	1	Nylon	Red	—
④	Waterproof Silicone	—	1	Silica gel	Black	—
③	Contact	—	1	F.Ag/SUS	Plating silver	—
②	Base	—	1	Nylon	Black	—
①	Terminal	—	4	Copper(0.3t)	Plating silver	—

APPROVALS		DATE	ELECTRONICS CO.,LTD	
DRAWN	J.X.Zhang	2014/6/13	HR00	

CHECKED		TITLE:	TACT SWITCHS	
APPROVALS		PART NO.	K2-1110DP-□□□□-□□	
TOLERANCES ARE		SCALE: 1:1	PROJ: 1 OF 1	
30~0.10		UNIT: mm	SHEET 1 OF 1	
10~30		ANGLE		
5~10		±2°		
~5		DRAWING NO.		

ECN NO.	REV.	DATE.	DESCRIPTION.	CHANGE.	CHECK.	APPRO.
	A		NEW			