

# LPO Series Toggle Switches

## SPECIFICATIONS

**RATING:** 15A 125VAC/20A 125/150VAC

**INSULATION RESISTANCE:** DC 500V 200M $\Omega$  Min.

**CONTACT RESISTANCE:** DC 2-4V 1A 20m $\Omega$  Max.

**WITHSTAND VOLTAGE:** AC 1500V Min.

## HOW TO ORDER

MODEL NO.	ACTUATOR	BUSHING	TERMINATIONS	CONTACT RATING	ROHS SOLDERING
703	703A	A1	B1	Q= 20A / 125VAC	<div> <input type="checkbox"/> Rohs Compliant  <input type="checkbox"/> R Rohs &amp; Lead Free         </div>
704-1	704-1A	A2	B2		
704-2	704-2B	A3	B3		
704-2A	705	A4	B4		
705A	706-1		H1		
706-1A	706-2		H2		
706-2B	706-2A		H3		
708-1	709-1		H4		
			H5		
Standard : A3 - B2 - H2					

## SWITCH FUNCTION

NO. POLES	UL	MODEL NO.	SWITCH FUNCTION			CONNECTED TERMINALS /SCHEMATIC		
			POS.1	POS.2	POS.3	POS.1	POS.2	POS.3
SP	√	703	OFF	NONE	ON	OPEN	N/A	1-3
		703A	OFF	NONE	MOM			
	√	704-1	ON	NONE	ON	2-3 	OPEN	2-1 
		704-1A	MOM	NONE	ON			
	√	704-2	ON	OFF	ON			
		704-2A	MOM	OFF	ON			
		704-2B	MOM	OFF	MOM			
DP	√	705	OFF	NONE	ON	OPEN	N/A	1-3 4-6
		705A	OFF	NONE	MOM			
	√	706-1	ON	NONE	ON	2-3,5-6 	OPEN	2-1,5-4 
		706-1A	MOM	NONE	ON			
	√	706-2	ON	OFF	ON			
		706-2A	MOM	OFF	ON			
		706-2B	MOM	OFF	MOM			
3P		708-1	OFF	NONE	ON	2-3,5-6 8-9,	OPEN	1-2,4-5 7-8,
4P		709-1	OFF	NONE	ON	2-3, 5-6 8-9,11-12	OPEN	1-2, 4-5 7-8,10-11

MOM=MOMENTARY

# LPO Series Toggle Switches

## POLE OPTIONS



**SPST**  
703-A3-B2-H2

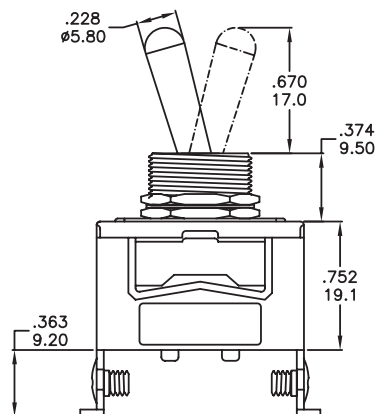
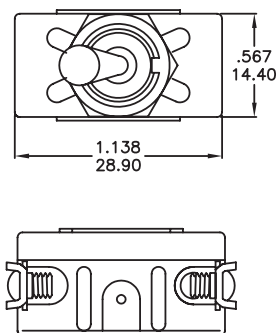

**SPDT**  
704-A3-B2-H2

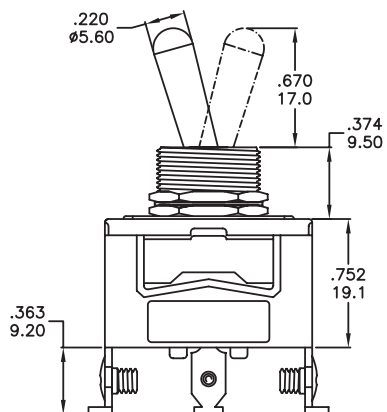
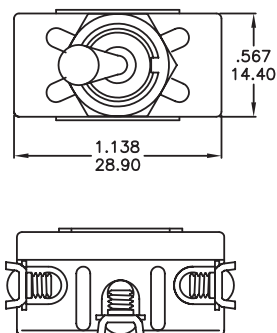

**DPST**  
705-A3-B2-H2

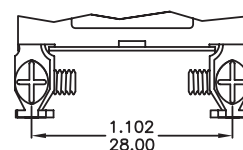
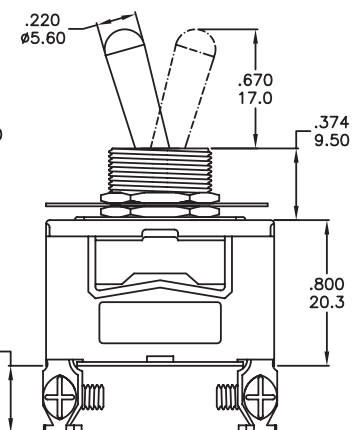
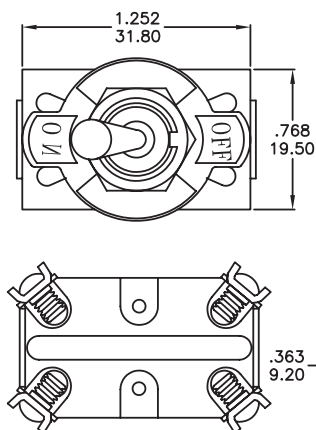

**DPDT**  
706-1-A3-B2-H2

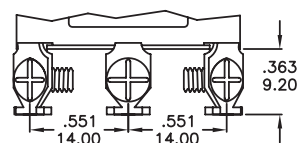
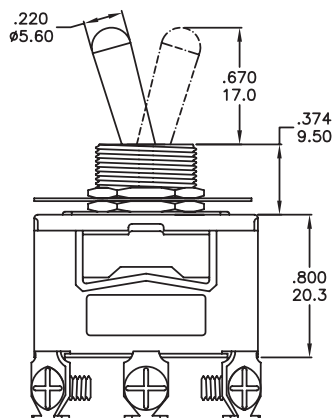
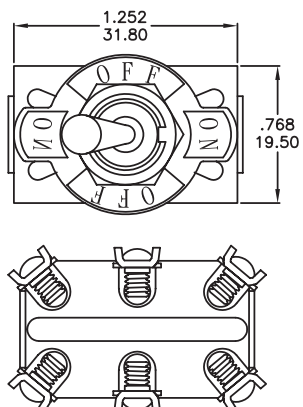

# LPO Series Toggle Switches



**SPST**  
**708-A3-B2-H2**

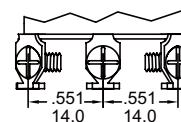
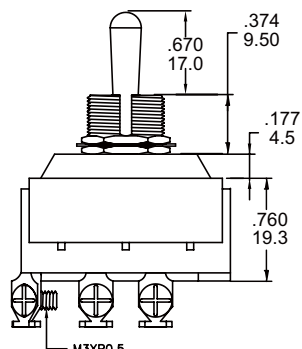
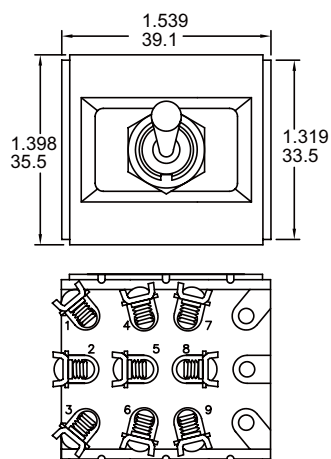

**SPDT**  
**709-A3-B2-H2**

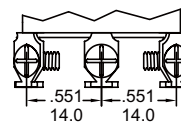
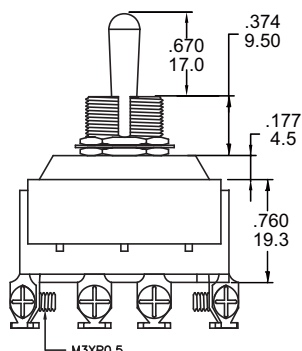
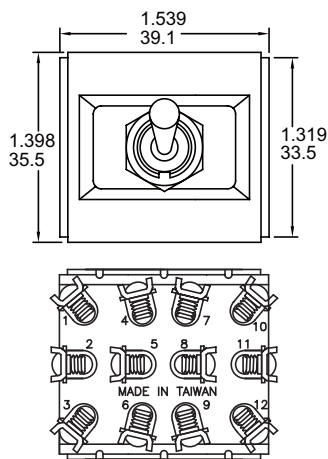

## ACTUATOR OPTIONS

A1

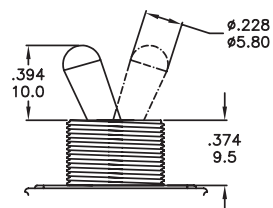

A2

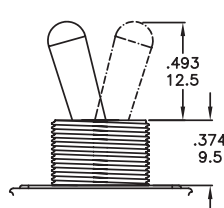

A3

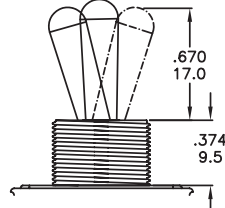

A4

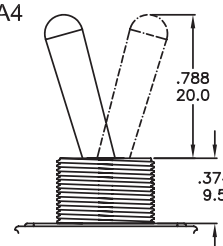

## BUSHING OPTIONS

B1

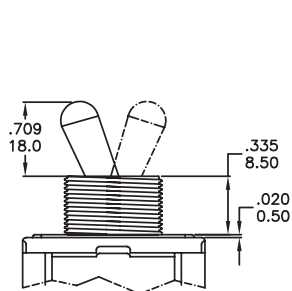

B2

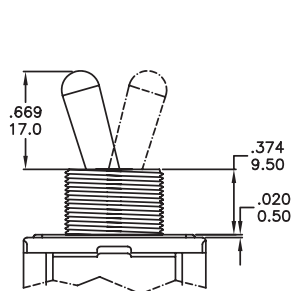

B3

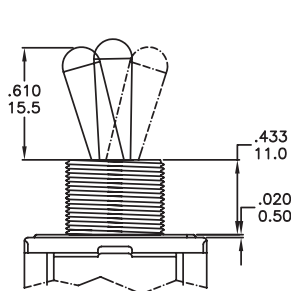

B4

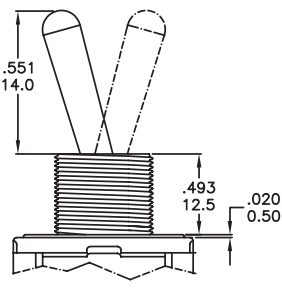

## TERMINATION OPTIONS

H1

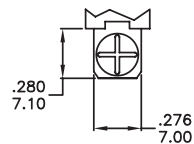

H2

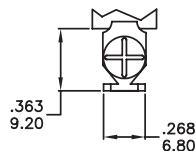

H3

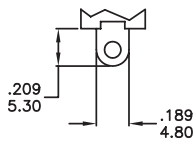

H4

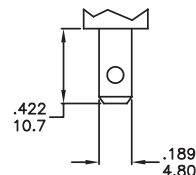

H5

