

SLE6 • SLE10

Dust Proof

Miniature Power Rocker Switches

C-US UL CSA VDE SEMKO

RoHS Compliant

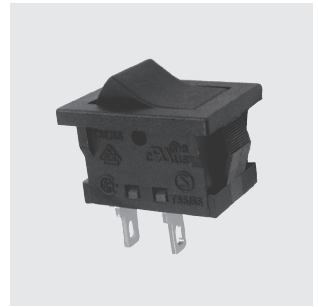

Features















1. C-US UL , CSA , VDE and SEMKO approved products
2. Snap-in panel mounting
3. Compact size is suited for space-saving design.
4. Best suited for power supply of equipment.
5. Dust-proof type
6. Breaking distance is 3 mm or over.

Specifications

Rating	SLE6	Max.	6A 125VAC・4A 250AC (Resistive load.)
		Min.	10mA 5VAC/DC (Resistive load.)
	SLE10	Max.	10A 125VAC・5A 250VAC (Resistive load.)
		Min.	10mA 5VAC/DC (Resistive load.)
Initial contact resistance		20mΩ max. (1A 2～4VDC)	
Dielectric strength		1,500VAC 1 minute (Between terminals)	
Insulation resistance		100MΩ min. (Between terminals) (500VDC)	
Electrical life		10,000 cycles	
Operating force		2.45～12.7N	
Operating temperature range		-25～+85℃	
Storage temperature range		-40～+85℃	

Part Numbering

SLE 6 A 2 - 5 - 50

Series code	Current	Switching function	Terminal style	Rocker design	Rubber cover installation																												
<table><tr><td>6</td><td>6A</td></tr><tr><td>10</td><td>10A</td></tr></table>	6	6A	10	10A		<table><tr><td>A</td><td>ON — OFF</td></tr><tr><td>D</td><td>ON — ON</td></tr></table>	A	ON — OFF	D	ON — ON		<table><tr><td>None</td><td>Solder Terminal</td></tr><tr><td>2</td><td>#187 TAB (t=0.5)</td></tr><tr><td>5</td><td>#187 TAB (t=0.8)</td></tr><tr><td>4</td><td>R/A Right Angle Terminal</td></tr></table>	None	Solder Terminal	2	#187 TAB (t=0.5)	5	#187 TAB (t=0.8)	4	R/A Right Angle Terminal	<table><tr><td>None</td><td>Unfigured</td></tr><tr><td>5</td><td></td></tr><tr><td>6</td><td></td></tr><tr><td>7</td><td></td></tr><tr><td>8</td><td></td></tr><tr><td>9</td><td></td></tr></table>	None	Unfigured	5		6		7		8		9	
6	6A																																
10	10A																																
A	ON — OFF																																
D	ON — ON																																
None	Solder Terminal																																
2	#187 TAB (t=0.5)																																
5	#187 TAB (t=0.8)																																
4	R/A Right Angle Terminal																																
None	Unfigured																																
5																																	
6																																	
7																																	
8																																	
9																																	

Approvals

UL File No.E43275
CSA File No.LR38341
VDE License No.120752
SEMKO File No.1312452

Terminal Styles

Terminal styles	Solder Terminal	TAB#187		Right Angle Terminal
styles	None	2	5	4
Dimensions	 t=0.8	 t=0.5	 t=0.8	 t=0.8

Marking Color

Frame color:Rocker color	Marking color
Black	White

The black color is standard for the frame and the rocker.
The gray and the ivory colors are also available as custom-made items.

SLE6 • SLE10

SLE6A
SLE6D
SLE10A
SLE10D

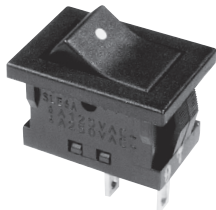

SolderTerminal

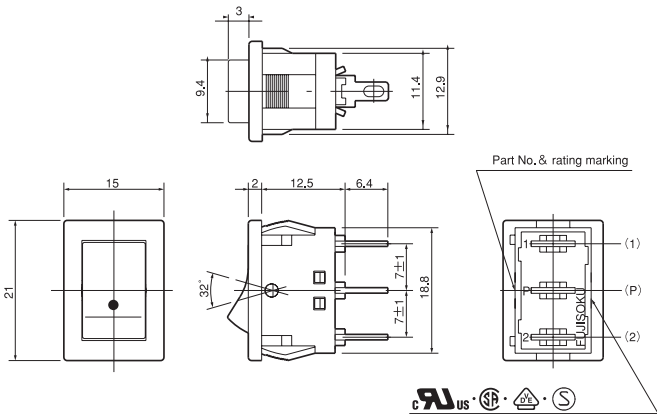

The switching function Type "A" is without terminal number (2).

Switching function	Viewed from part No. & rating marking side	
Part No.		
SLE6A-	ON	OFF
SLE10A-	ON	OFF
Connecting terminals	P- 1	-
SLE6D-	ON	ON
SLE10D-	ON	ON
Connecting terminals	P- 1	P- 2

: Show the rocker design number.

SLE6A2
SLE6D2
SLE10A2
SLE10D2

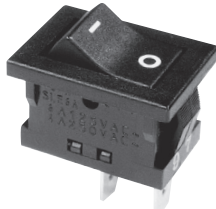

TAB # 187

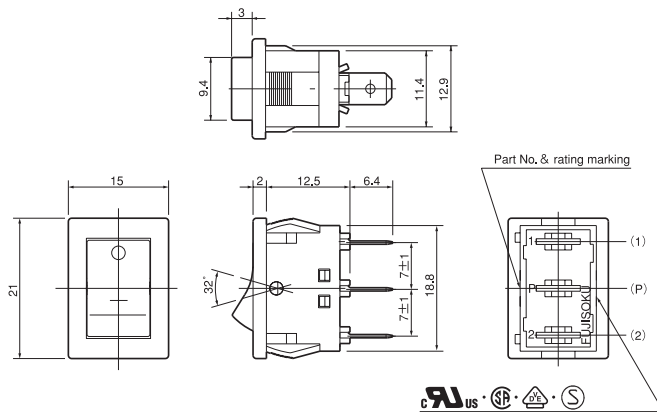

The switching function Type "A" is without terminal number (2).

Switching function	Viewed from part No. & rating marking side	
Part No.		
SLE6A2-	ON	OFF
SLE10A2-	ON	OFF
Connecting terminals	P- 1	-
SLE6D2-	ON	ON
SLE10D2-	ON	ON
Connecting terminals	P- 1	P- 2

: Show the rocker design number.

SLE6A4
SLE6D4
SLE10A4
SLE10D4

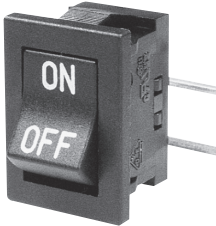

Right Angle Terminal

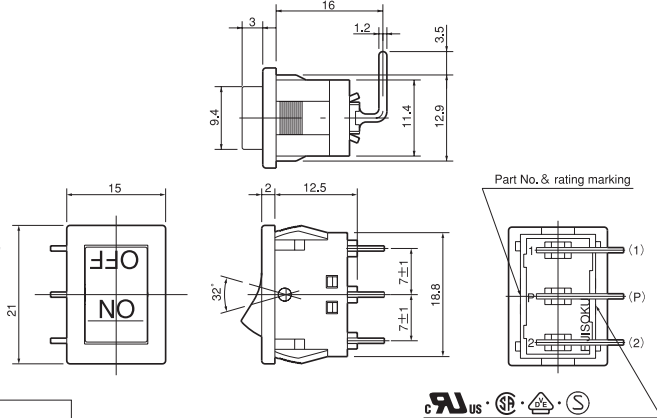

The switching function Type "A" is without terminal number (2).

Switching function	Viewed from part No. & rating marking side	
Part No.		
SLE6A4-	ON	OFF
SLE10A4-	ON	OFF
Connecting terminals	P- 1	-
SLE6D4-	ON	ON
SLE10D4-	ON	ON
Connecting terminals	P- 1	P- 2

: Show the rocker design number.

SLE6A-50 SLE6D-50
SLE6A2-50 SLE6D2-50
SLE6A4-50 SLE6D4-50
SLE6A5-50 SLE6D5-50



Rubber cover installation

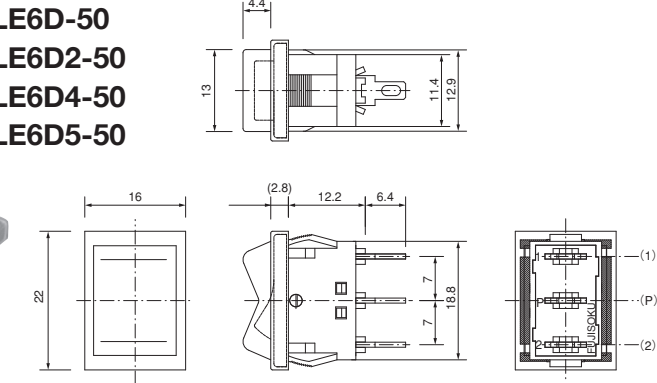

The switching function Type "A" is without terminal number (2).

Switching function	Viewed from part No. & rating marking side	
Part No.		
SLE6A-50 SLE6A2-50 SLE6A4-50 SLE6A5-50	ON	OFF
Connecting terminals	P- 1	-
SLE6D-50 SLE6D2-50 SLE6D4-50 SLE6D5-50	ON	ON
Connecting terminals	P- 1	P- 2

PC Hole Layouts

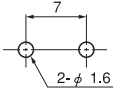
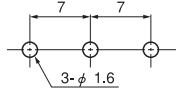
Series	SLE6A4 SLE10A4	SLE6D4 SLE10D4
Dimensions		

Panel Cut-Out Dimensions

Switches



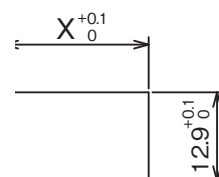



Panel thickness	X
0.75~1.25	19.2
1.25~3.5	19.4



Switch Guard Installation

Panel thickness	X
0.75~2.8	19.4

Table of Part Numbers

Current	Terminal styles	Switching function						
Part No. and rating marking side								
6A	Solder Terminal	ON—OFF	SLE6A	SLE6A—5	SLE6A—6	SLE6A—7	★SLE6A—8	☆SLE6A—9
		ON—ON	SLE6D	★SLE6D—5	☆SLE6D—6	▲SLE6D—7	▲SLE6D—8	▲SLE6D—9
	t=0.5 TAB	ON—OFF	SLE6A2	SLE6A2—5	SLE6A2—6	SLE6A2—7	▲SLE6A2—8	☆SLE6A2—9
		ON—ON	SLE6D2	★SLE6D2—5	▲SLE6D2—6	★SLE6D2—7	▲SLE6D2—8	★SLE6D2—9
	t=0.8 TAB	ON—OFF	▲SLE6A5	★SLE6A5—5	★SLE6A5—6	★SLE6A5—7	▲SLE6A5—8	★SLE6A5—9
		ON—ON	▲SLE6D5	▲SLE6D5—5	▲SLE6D5—6	▲SLE6D5—7	▲SLE6D5—8	★SLE6D5—9
	Right Angle Terminal	ON—OFF	▲SLE6A4	★SLE6A4—5	★SLE6A4—6	★SLE6A4—7	▲SLE6A4—8	▲SLE6A4—9
		ON—ON	★SLE6D4	★SLE6D4—5	★SLE6D4—6	★SLE6D4—7	▲SLE6D4—8	▲SLE6D4—9
10A	Solder Terminal	ON—OFF	★SLE10A	★SLE10A—5	★SLE10A—6	☆SLE10A—7	▲SLE10A—8	★SLE10A—9
		ON—ON	★SLE10D	★SLE10D—5	▲SLE10D—6	▲SLE10D—7	▲SLE10D—8	▲SLE10D—9
	t=0.5 TAB#187	ON—OFF	★SLE10A2	SLE10A2—5	SLE10A2—6	★SLE10A2—7	▲SLE10A2—8	★SLE10A2—9
		ON—ON	▲SLE10D2	★SLE10D2—5	★SLE10D2—6	▲SLE10D2—7	▲SLE10D2—8	▲SLE10D2—9
	t=0.8 TAB#187	ON—OFF	▲SLE10A5	☆SLE10A5—5	★SLE10A5—6	▲SLE10A5—7	▲SLE10A5—8	★SLE10A5—9
		ON—ON	★SLE10D5	▲SLE10D5—5	▲SLE10D5—6	★SLE10D5—7	▲SLE10D5—8	▲SLE10D5—9
	Right Angle Terminal	ON—OFF	▲SLE10A4	★SLE10A4—5	▲SLE10A4—6	★SLE10A4—7	▲SLE10A4—8	▲SLE10A4—9
		ON—ON	★SLE10D4	▲SLE10D4—5	▲SLE10D4—6	▲SLE10D4—7	▲SLE10D4—8	▲SLE10D4—9

Fit on rubber cover

Current	Terminal styles	Switching function	Part No.
6A	Solder Terminal	ON—OFF	★SLE6A—50
		ON—ON	★SLE6D—50
	t=0.5 TAB	ON—OFF	★SLE6A2—50
		ON—ON	★SLE6D2—50
	t=0.8 TAB	ON—OFF	★SLE6A5—50
		ON—ON	★SLE6D5—50
	Right Angle Terminal	ON—OFF	★SLE6A4—50
		ON—ON	★SLE6D4—50

Handling Precautions

1. Soldering Specifications

(1) Manual Soldering

Device : Soldering iron
380°C, Max.; 3 seconds, Max.

※The tab terminals cannot be soldered

2. Precautions for panel mounting

Page.....310

Switch Guard

For details, refer to page 308.