

APE1F-5M-10-2-Z

Subminiature Pushbutton Switches

Washable

RoHS Compliant

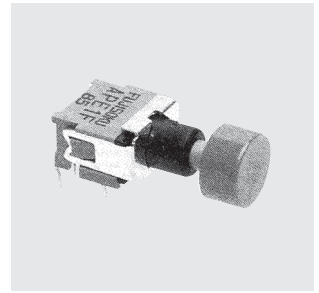

Features

1. Twin-contact clip mechanism for high reliability.
2. Process sealed structure
3. Gold-plated contacts.
4. Terminal pin pitch: 2.54 mm.

Specifications

Rating	Max:100mA 48VAC/DC Min:1μA 20mVAC/DC 0.4VA (Voltage range 20mV~28V) (Current range 1μA~20mA)
Initial contact resistance	50mΩ max. (1.5mA 200μVAC)
Dielectric strength	500VAC 1 minute
Insulation resistance	500MΩ min. (500VDC)
Electrical life	10,000 operations at maximum rating. 50,000 operations at min. rating or 0.4VA
Operating force	0.78~2.94N
Operating temperature range	-20~+85°C
Storage temperature range	-40~+85°C

Optional Accessories

《Sold separately》

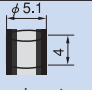
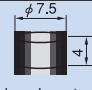
Part name	Color Button	
Dimensions		
	Polycarbonate resin	Polycarbonate resin
White	140000481572	140000481528
Red	140000481571	140000481529
Black	140000481495	140000481499

Color Button Mounting

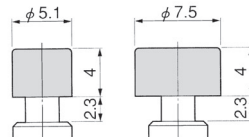

PC Hole Layouts

《Top view》

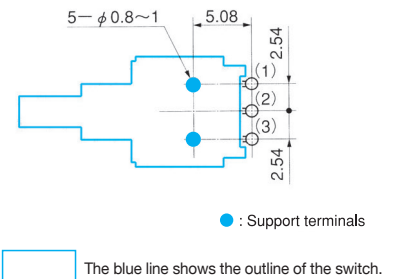

SPDT

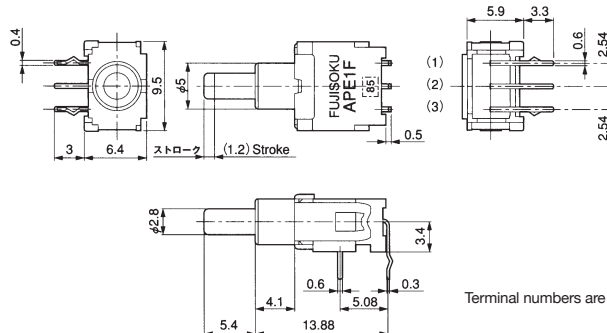

Switching function	ON	Push
Part No.	APE1F-5M-10-2-Z	(ON)
Connecting terminals	2-3	2-1

Terminal numbers are not shown on the switch.

PC