

SPL6B,C



SPECIFICATIONS

CIRCUIT: SPST

CONTACT RATING: 50mA

VOLTAGE RATING: 12VDC

DIELECTRIC WITH STANDING VOLTAGE: 250 VAC for 1 minute

CONTACT RESISTANCE: 100mΩ max. (initial)

INSULATION RESISTANCE: 100MΩ min.

OPERATION LIFE: 1,000,000 cycles min.

SOLDERING SPECIFICATION: 260°C for 3 seconds

SPL6B

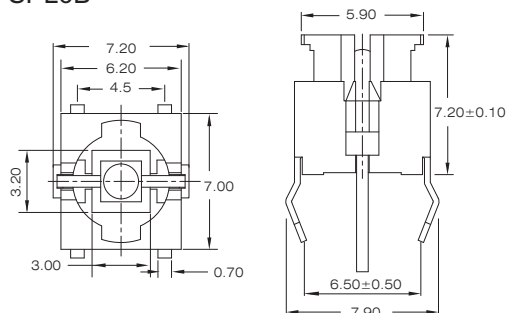

SPL6C

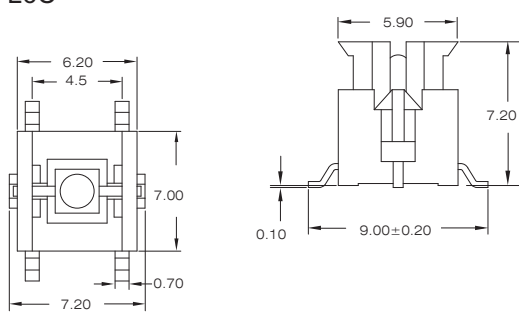

PCB LAYOUT

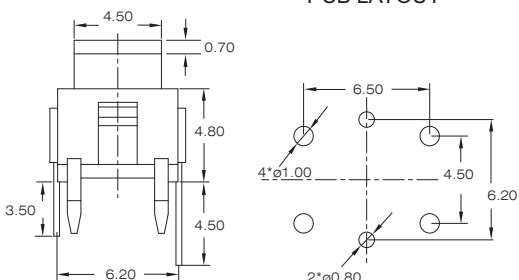

PCB LAYOUT

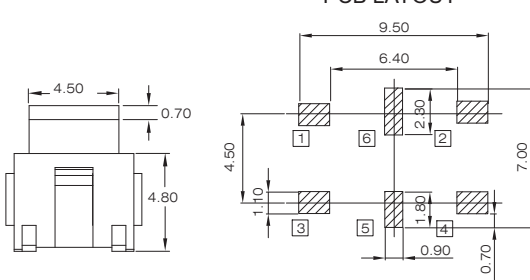

CIRCUIT DIAGRAM

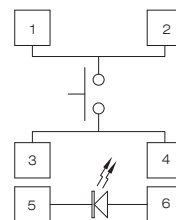

CAP OPTION

A

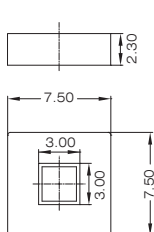

B

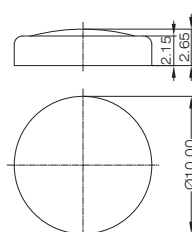

C

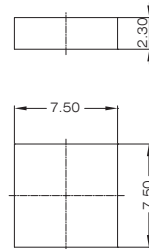

HOW TO ORDER

SPL6	<input type="checkbox"/>	<input type="checkbox"/>	<input type="checkbox"/>	<input type="checkbox"/>	<input type="checkbox"/>	<input type="checkbox"/>	<input type="checkbox"/>	<input type="checkbox"/>
SWITCH OPERATION	FORCE	LED COLOR/ KINDS	Frame/ Color	CAP MODEL	CAP COLOR	PACKAGE STYLE	RoHS CODE	
<div style="display: flex; justify-content: space-between;"> <div style="width: 20%;"> <p>B = Regular Type B1= DIP Type (LED pitch differs from B Type) C = SMT Type C1=SMT Type (LED outward) C2= SMT Type (LED outward, Lead pitch 10.0, total height 7.8)</p> <p>Operation Force 1= 100gf 2= 160gf 12=180gf 3= 260gf</p> </div> <div style="width: 20%;"> <p><input type="checkbox"/> = without led 1 = WHITE 3 = RED 36=RED、GREEN 4 = ORANGE 5 = YELLOW 56=YELLOW、GREEN 6 = GREEN 63=GREEN、RED 66=PURE GREEN 7 = BLUE 73=BLUE、RED 74= BLUE、ORANGE 75=BLUE、YELLOW</p> </div> <div style="width: 20%;"> <p>2=BLACK 9=GREY</p> <p><input type="checkbox"/> = Without Frame 1 = With Frame</p> <p><input type="checkbox"/> = NORMAL L= HIGHLIGHT N=ADD ZENER</p> </div> <div style="width: 20%;"> <p><input type="checkbox"/> = without cap A= <input type="checkbox"/> B= <input type="checkbox"/> C= <input type="checkbox"/> D= with film</p> </div> <div style="width: 20%;"> <p>1=WHITE 2=BLACK 3= RED 5= YELLOW 6= GREEN 7= BLUE</p> </div> <div style="width: 20%;"> <p>H=RoHS Compliant</p> <p><input type="checkbox"/> = bag T/R= Tape & Reel</p> </div> </div>								