



SPECIFICATIONS

CONTACT RATING: 3A @125 VAC or 250 VAC
6A @250 VAC

ELECTRICAL LIFE: 10,000 cycles

CONTACT RESISTANCE: 30 mΩ max. initial

INSULATION RESISTANCE: 100 MΩ min. 500VDC

DIELECTRIC STRENGTH: 1,500 VAC / 1 min.

OPERATING TEMPERATURE: -20°C to +85°C



DIMENSIONS

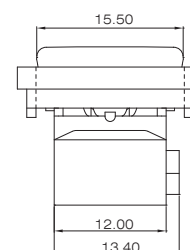
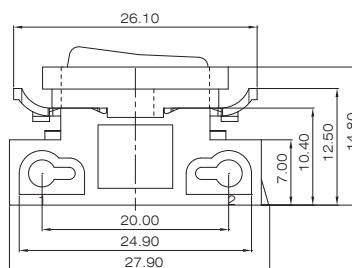
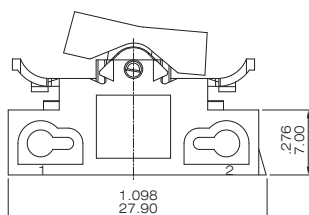
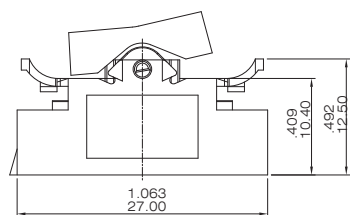
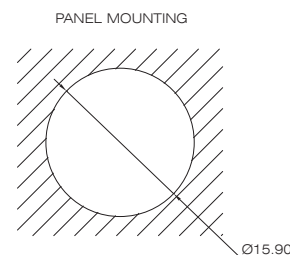
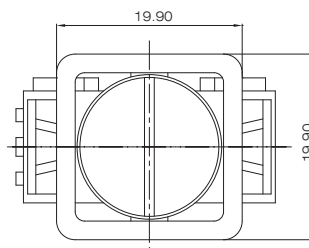
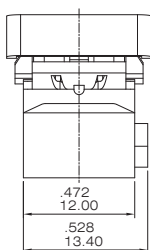
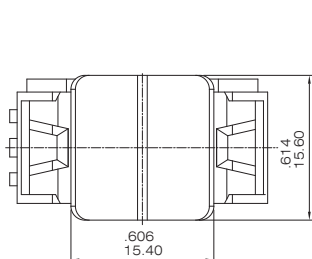

R6010-R50-1-06

R6010-R51-1-S50-1-06

HOW TO ORDER

R6010 - R50 - 2 ☐ - S50 - 2 - 06 - ☐ - H

Switch Function:
R6010: SPST

Actuator:
50 = Squareness
51= Roundness
52= Long strip
53= Toggle form
54= Ø20 Roundness

Actuator Color:
1= White
2= Black
3= Red

Actuator Marking:
1= ○ I
2= ○ -

RoHS compliant

Degrees of temperature:
☐ =T85
T = T125
H =T150
G = T200

Ratings:
06=6A 250VAC

Frame Color:
1= White
2= Black
3= Red

Frame:
(none)
S50