

### SPECIFICATIONS

CONTACT RATING:Q: 3A @125 VAC or 28 VDC ( Q: terminal option)

ELECTRICAL LIFE:30,000 make-and-break cycles at full load

CONTACT RESISTANCE: 20 mΩ max. initial @2-4 VDC,100 mA

INSULATION RESISTANCE: 1,000 MΩ min.

DIELECTRIC STRENGTH: 1,500 V RMS @ sea level.

OPERATING TEMPERATURE: -30°C to +85°C

### MATERIALS

CASE - diallyl phthalate ( DAP )(UL94V-0)

ACTUATOR- Nylon , black standard

BUSHING - Copper alloy , nickel plated

HOUSING - Stainless Steel

CONTACT AND TERMINAL - Copper alloy, silver plated

SWITCH SUPPORT - Copper alloy , tin-plated

**How do you build the switches you need!!**

The RS-4 / RS-5 , please see the (A) ;

The RS-6/RS-7/RS-8/RS-9, please see the (B)

(A) **RS** - **4** - **R1** - **2** - **C** **Q** - **E** - **A5S** -

Switches Function		Actuator		Actuator Color		Termination		Epoxy seal		RoHS code	
RS-4	SP on-none-on	R1	7.62 width	1	white	B	solder lug	(none)	none seal	H = RoHS Compliant	
RS-4B	SP on-none-(on)	R2	5.84 width	2	Black	C	P.C	E	epoxy seal		
RS-4A	SP on-off-on	R3	5.76 width	3	Red	D	wire wrap				
RS-4H	SP (on)-off-(on)			The other color is available for special inquires							
RS-4I	SP on-off-(on)			<b>Marking</b>  (none) No marking 1 2 3 4 5		<b>Contact Material</b>  Q silver plated R gold plated G gold over silver K gold / tin		<b>Vertical support Bracket</b>  (none) A5 straight type A5S snap-in type A6 straight type A6S snap-in type			
RS-5	DP on-none-on										
RS-5B	DP on-none-(on)										
RS-5A	DP on-off-on										
RS-5H	DP (on)-off-(on)										
RS-5I	DP on-off-(on)										
RS-5C	DP on-on-on										

(B) **RS** - **6** - **R2** - **2** - **Q** - **E** - **S** -

Horizon Right Angle	Vertical Right Angle	Switches Function	Actuator		Contact Material	Epoxy seal		RoHS code			
RS-6	RS-8	SP on-none-on	R1	7.62 width	Q	silver plated	(none)	H = RoHS Compliant			
RS-6B	RS-8B	SP on-none-(on)	R2	5.84 width	R	gold plated	E		none seal		
RS-6A	RS-8A	SP on-off-on	R3	5.76 width	G	gold over silver			epoxy seal		
RS-6H	RS-8H	SP (on)-off-(on)			K	gold / tin					
RS-6I	RS-8I	SP on-off-(on)							<b>Support Bracket</b>		
RS-7	RS-9	DP on-none-on								(none)	std. straight snap-in type
RS-7B	RS-9B	DP on-none-(on)								S	
RS-7A	RS-9A	DP on-off-on									
RS-7H	RS-9H	DP (on)-off-(on)									
RS-7I	RS-9I	DP on-off-(on)									
RS-7C	RS-9C	DP on-on-on									
			<b>Actuator Color</b>								
			1	white							
			2	Black							
			3	Red							
			The other color is available for special inquires								



TS40-R

## Sub-Miniature Rocker Switches



## SPDT



Model No.	Switching position		
RS-4	ON	none	ON
RS-4A	ON	OFF	ON
RS-4B	ON	None	(ON)
RS-4H	(ON)	OFF	(ON)
RS-4I	ON	OFF	(ON)
Term. Comm.	2-3	open	2-1

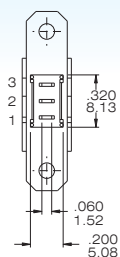
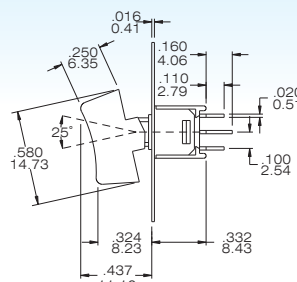
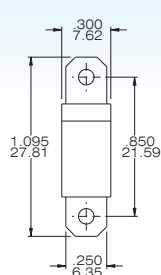

RS-4 - R1-2-BQ

## DPDT



Model No.	Switching position		
RS-5	ON	none	ON
RS-5A	ON	OFF	ON
RS-5B	ON	None	(ON)
RS-5H	(ON)	OFF	(ON)
RS-5I	ON	OFF	(ON)
Term. Comm.	2-3,5-6	open	2-1,5-4
3 way switches (SP3T)			
RS-5C	ON	ON	ON
Term. Comm.	2-3,5-6	2-3,5-4	2-1,5-4

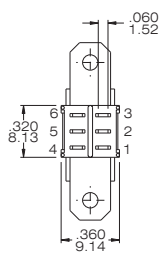
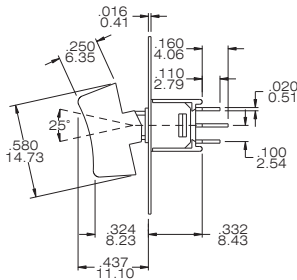
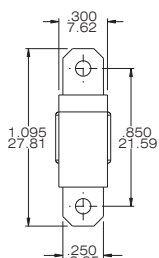

RS-5- R1-2-BQ

## SPDT

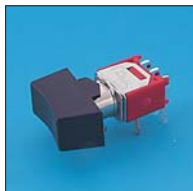

Model No.	Switching position		
RS-6	ON	none	ON
RS-6A	ON	OFF	ON
RS-6B	ON	None	(ON)
RS-6H	(ON)	OFF	(ON)
RS-6I	ON	OFF	(ON)
Term. Comm.	2-3	open	2-1

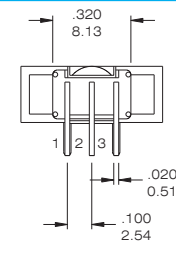
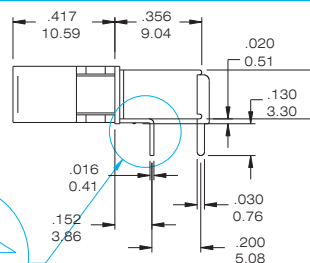
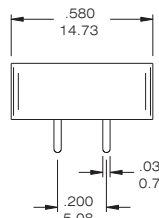

RS-6 - R2-2-Q / RS-6-R2-2-Q-S

## DPDT



Model No.	Switching position		
RS-7	ON	none	ON
RS-7A	ON	OFF	ON
RS-7B	ON	None	(ON)
RS-7H	(ON)	OFF	(ON)
RS-7I	ON	OFF	(ON)
Term. Comm.	2-3,5-6	open	2-1,5-4
3 way switches (SP3T)			
RS-7C	ON	ON	ON
Term. Comm.	2-3,5-6	2-3,5-4	2-1,5-4

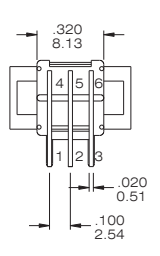
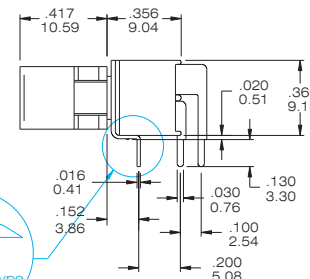
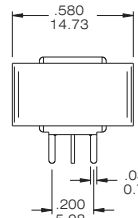

RS-7- R1-2-Q / RS-7-R1-2-Q-S

## SPDT



Model No.	Switching position		
RS-8	ON	none	ON
RS-8A	ON	OFF	ON
RS-8B	ON	None	(ON)
RS-8H	(ON)	OFF	(ON)
RS-8I	ON	OFF	(ON)
Term. Comm.	2-3	open	2-1

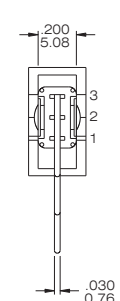
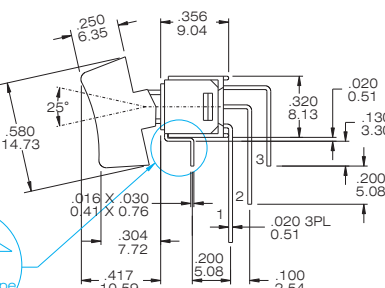
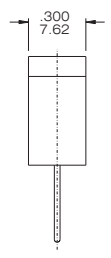

RS-8 - R1-2-Q / RS-8-R1-2-Q-S

## DPDT



Model No.	Switching position		
RS-9	ON	none	ON
RS-9A	ON	OFF	ON
RS-9B	ON	None	(ON)
RS-9H	(ON)	OFF	(ON)
RS-9I	ON	OFF	(ON)
Term. Comm.	2-3,5-6	open	2-1,5-4
3 way switches (SP3T)			
RS-9C	ON	ON	ON
Term. Comm.	2-3,5-6	2-3,5-4	2-1,5-4

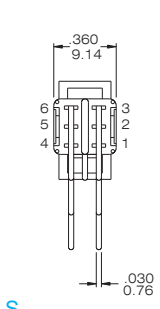
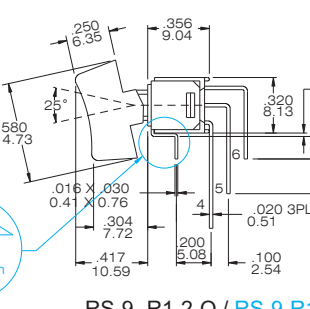
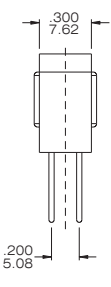

RS-9- R1-2-Q / RS-9-R1-2-Q-S

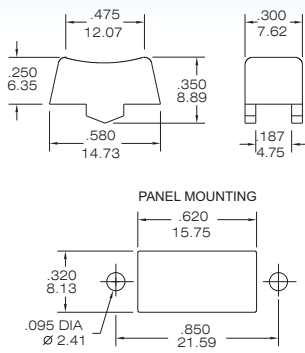
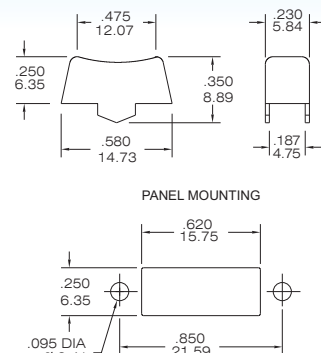
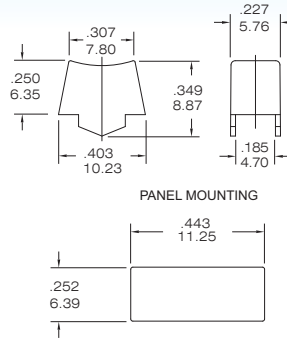
**TS40-R****Sub- Miniature Rocker Switches****Actuator Option****Actuator Color Option****R1****R2****R3**

Code	Color
1	White
2	Black(std.)
3	Red

Other colors, customized actuator marking available consult factory.

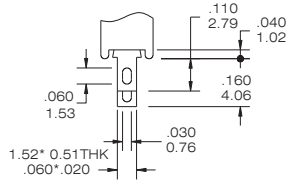
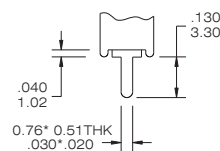
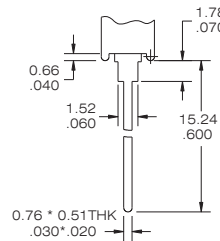
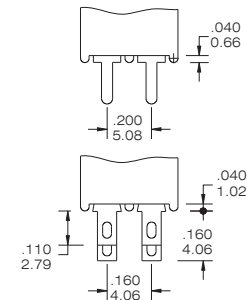
**TERMINAL OPTION (ONLY FOR THE RS-4/RS-5)****B Solder Lug(STD)****C PRINTED CIRCUIT****D Wire Wrap****DPDT****CONTACT MATERIAL OPTIONS**

CODE	CONTACT MATERIAL	TERMINAL MATERIAL	RATING
Q	Silver plated	Silver plated	3 A @ 125V AC or 28 V DC; 1.5 A @ 250 VAC
R	Gold plated over nickel plated	Gold plated over nickel plated	0.4VA MAX @ 20 V AC or DC MAX
G	Gold plated over silver plated	Gold plated over silver plated	0.4 VA MAX @ 20 V AC or DC MAX or 3 A @ 125V AC or 28 V DC; 1.5 A @ 250 VAC
K	Gold plated over nickel plated	Tin over nickel plated	0.4VA MAX @ 20 V AC or DC MAX

\* THE K option is only for some special item. Please inquire first when you need the "K" option

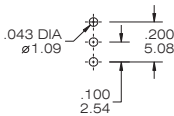
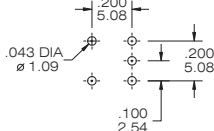
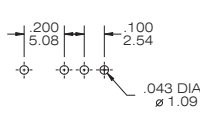
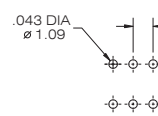
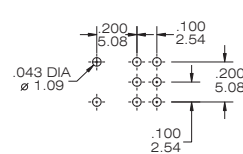
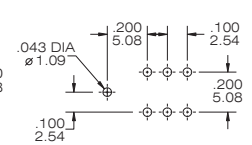
**P.C.B MOUNTING DIMENSION****RS-4 (PC terminal)****RS-6****RS-8****RS-5 (PC terminal)****RS-7****RS-9****VERTICAL SUPPORT BRACKET OPTION**

only for the RS-4/RS-5 . If you need the vertical support bracket , please build the terminal option is "C" code

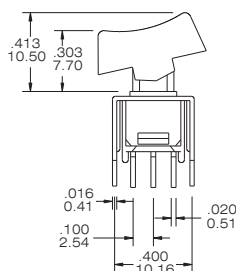
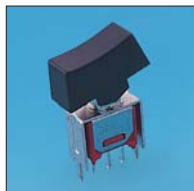
**A5/ A5S**

A5 (STD.)  
A6

A5S (Snap-in)  
A6S (Snap-in)

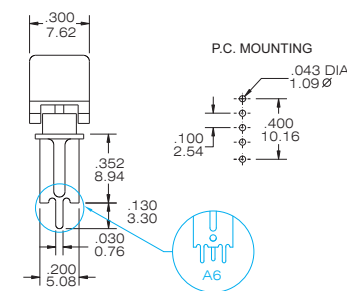

RS-4-R1-2-CQ-A5 / RS-4-R1-2-CQ-A6

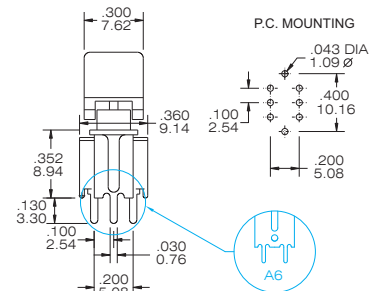

RS-5-R1-2-CQ-A5 / RS-5-R1-2-CQ-A6