



SPECIFICATIONS

CONTACT RATING: 2A, 125VAC; 1A, 250VAC

ELECTRICAL LIFE: 10,000 cycles

CONTACT RESISTANCE: 20mΩ max. (initial)

INSULATION RESISTANCE: 100MΩ min. 500VDC

DIELECTRIC STRENGTH: 500VAC/1 min.

OPERATING TEMPERATURE: -10°C to +70°C

MATERIALS

Bottom: Bakelite Board

Actuator: nylon

Shell: SPCC tin-plated

Terminal and Contact: C1100 1/2H, silver plated

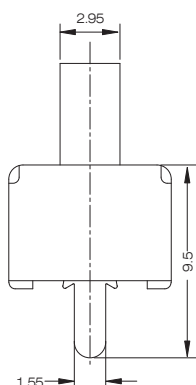
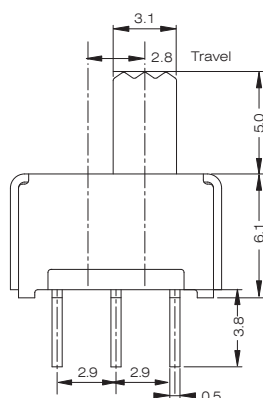

PCB layout

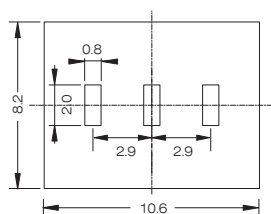
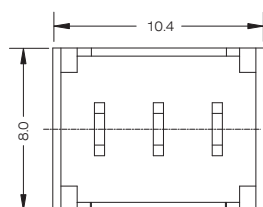

SL-A-C-H

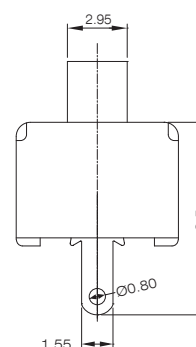
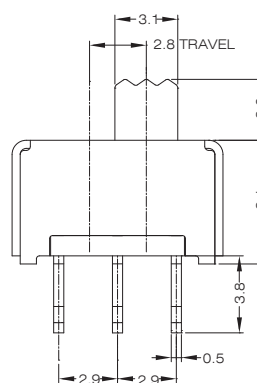

PCB layout

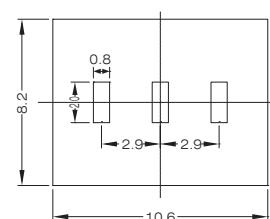
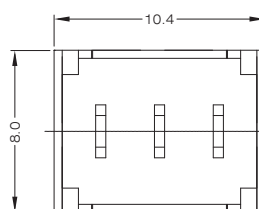

SL-A1-B-H

HOW TO ORDER

SL
SLIDE SWITCH

- [A]
HANDLE HEIGHT

- [C]
TERMINAL

[Q]
PLATING

- [H]
ROHS CODE:

A : 5.0 mm
A1: 3.0mm

B: Solder Lug
C: PC
H: Horizon
V: Vertical

Q: Silver plated
R: Gold plated

H = RoHS Compliant