

LT2

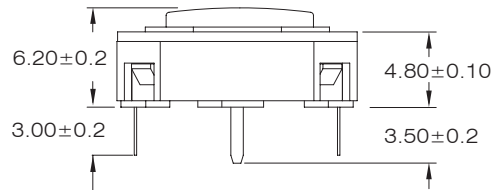

SPECIFICATIONS

CONTACT RATING: 100mA, 42VAC / DC
MECHANICAL LIFE: 1,000,000 cycles
CONTACT RESISTANCE: 100mΩ max. (initial)
INSULATION RESISTANCE: 1,000MΩ min.
DIELECTRIC STRENGTH: 2,000VAC
OPERATION FORCE: 3N±0.75N max.

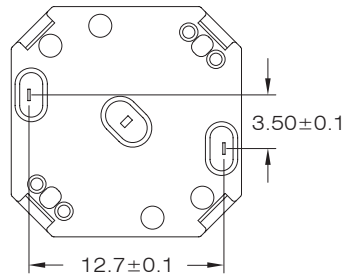

PC MOUNTING

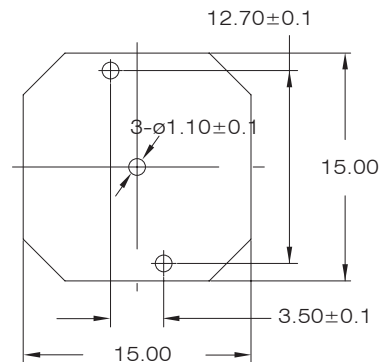
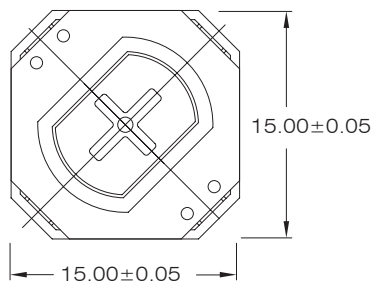

HOW TO ORDER

LT2 - 15 - HT - - - - - -

LT2 Series

Size:
19 : 19 x 19mm
15 : 15 x 15mm

HT material:
HT=High temperature

Plunger : T1/T2/T3

LED quantity:
0 : no LED 1 : one LED
2 : two LED

LED color
1 : white 3 : red 5 : yellow
6 : green 7 : blue

RoHS code:
H : RoHS Compliant

Contact material:
☐ = Au version tin-plated
Q = silver plated

Another LED color:
1 : white
3 : red
5 : yellow
6 : green
7 : blue