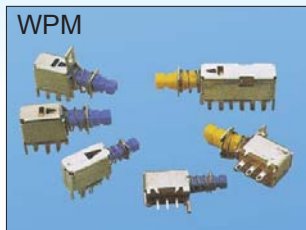
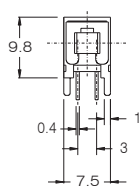
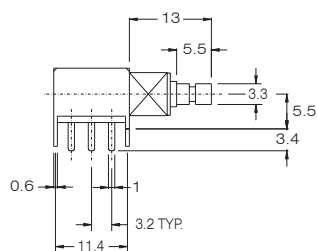
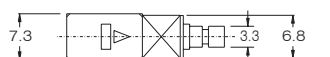
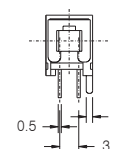
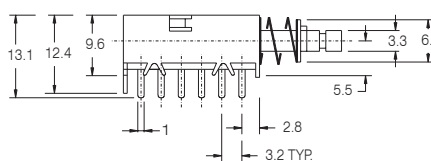
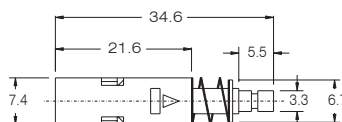
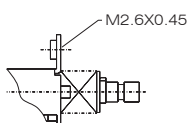
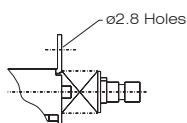
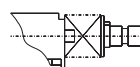
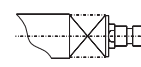
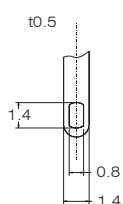
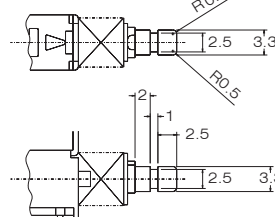
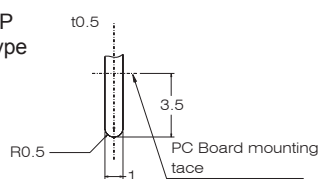

WPM

SPECIFICATIONS

RATING : 30V DC, 0.3A
 CONTACT RESISTANCE : 50mΩ max.
 INSULATION RESISTANCE : 500V DC-100MΩ min
 WITH STANDARD VOLTAGE: 500V AC-1minute
 LIFE CYCLE: 10,000 cycles
 OPERATING TEMPERATURE RANG: -20°C~+70°C

POLE
2 POLE

4 POLE

FRAME TYPE
M Type

H Type

B Type

S Type

TERMINAL TYPE
Terminal for lead wiring
Terminal for printed circuit
Shaft end style
W Type

P Type

OPERATION:
 L = LOCK
 N = NON LOCK

HOW TO ORDER

SERIES FRAME POLE TERMINAL OPERATION KNOB RoHS code
 — — — — — —

H = RoHS Compliant