

SPECIFICATIONS

**CONTACT RATING:** Dependent upon contact material

**MECHANICAL LIFE:** 50,000 make-and-break cycles.

**CONTACT RESISTANCE:** 20 mΩ max. initial @ 2-4VDC

100mA for both silver and gold plated contacts.

**INSULATION RESISTANCE:** 1,000 MΩ min.

**DIELECTRIC STRENGTH:** 1,000 Vrms min. @sea level.

**OPERATING TEMPERATURE:** -30°C to 85°C.

MATERIALS

**CASE:** Diallyl phthalate(DAP) (UL94V-0).

**PLUNGER:** Nylon 6/6,black.

**BUSHING:** Brass or zinc,nickel plated.

**HOUSING:** Stainless Steel.

**SWITCH SUPPORT:** Brass,tin plated.

**CONTACT/TERMINAL:** Copper alloy or Brass, with silver or gold plated.



HOW TO ORDER

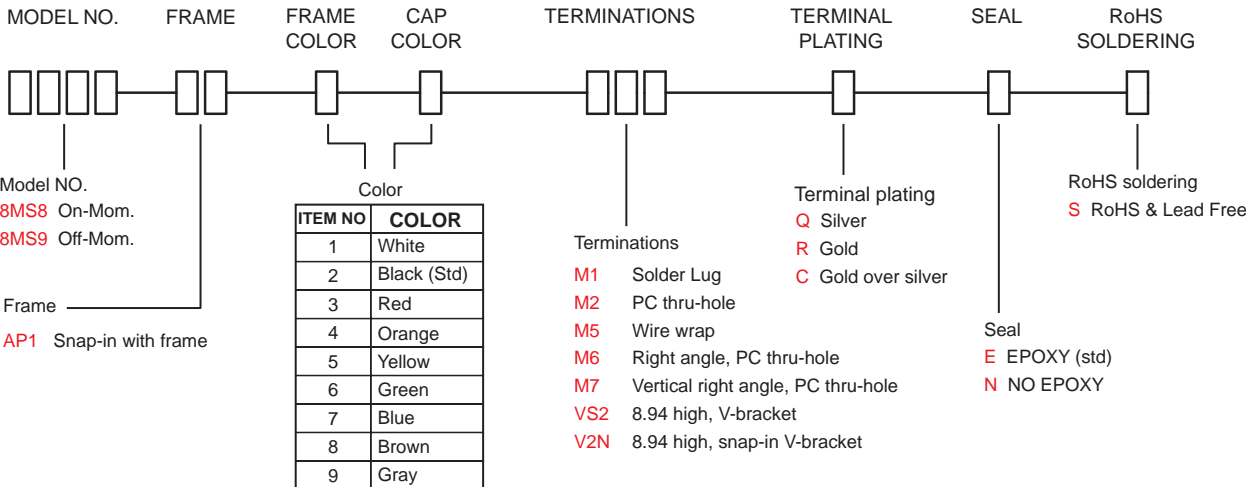
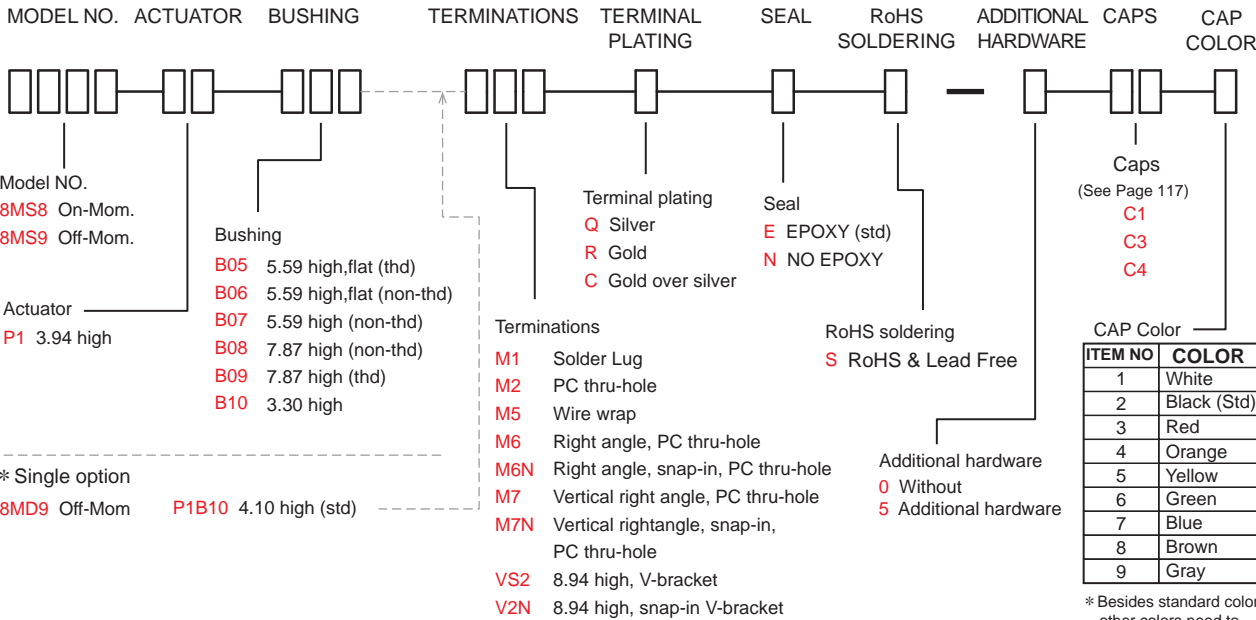

\* Besides standard color, other colors need to check stocks available.

SWITCH FUNCTION

NO. POLES	UL/CSA MODEL NO.	MODEL NO.	SWITCH FUNCTION		CONNECTED TERMINALS / SCHEMATIC	
			POS.1	POS.2	POS.1	POS.2
SP	Q2818	8MS8	ON	MOM	2-1 	2-3 
	Q2819	8MS9	OFF	MOM	OPEN 	1-3 
DP	Q2829	8MD9	OFF	MOM	OPEN 	1-3,4-6 

MOM=MOMENTARY

POLE OPTIONS

8M  
Pushbutton Switches

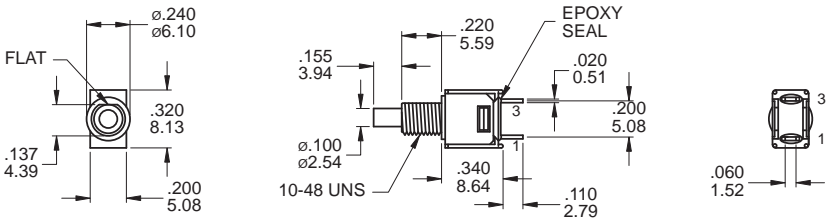

SPST

Part No. Shown : 8MS9P1B05M1QE

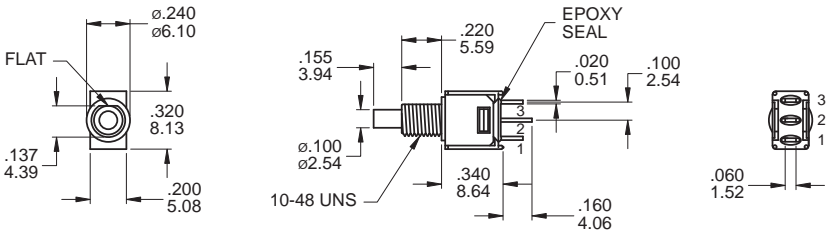

SPDT

Part No. Shown : 8MS8P1B05M1QE

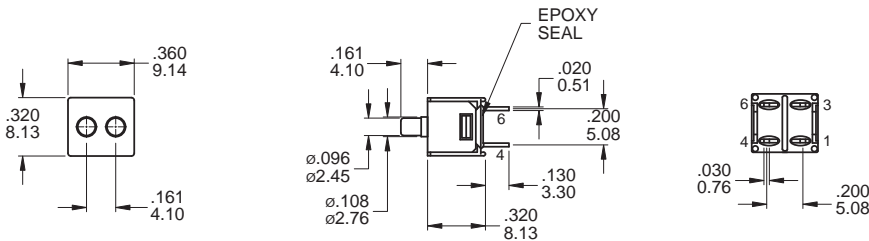

DPST

Part No. Shown : 8MD9P1B10M2RE

### BUSHING OPTIONS

#### B05 THD

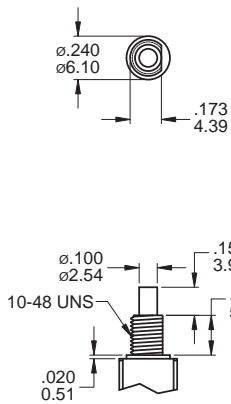

#### B06 NON-THD

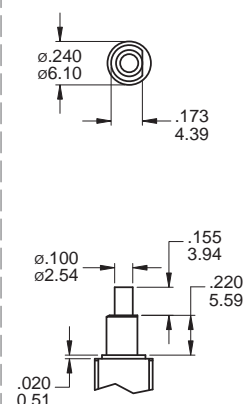

#### B07 NON-THD

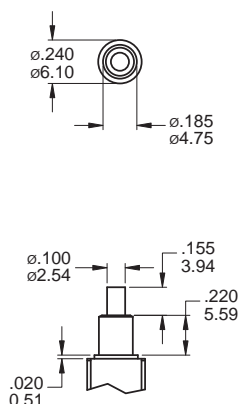

#### B08 NON-THD

#### B09 THD

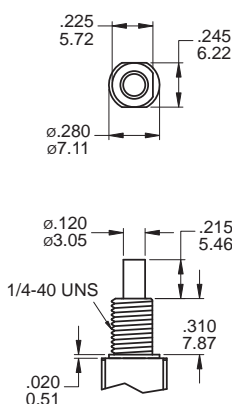

#### B10

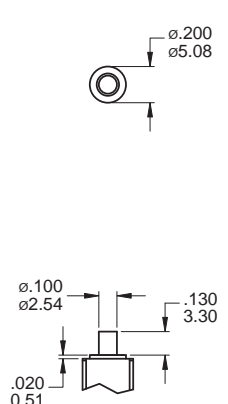

8M  
Pushbutton Switches

### TERMINATION OPTIONS

#### M1 Solder lug

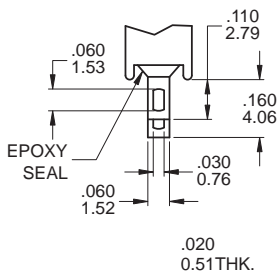

#### M2 PC Thru-hole

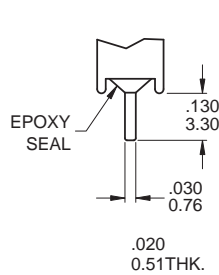

#### M5 Wire Wrap

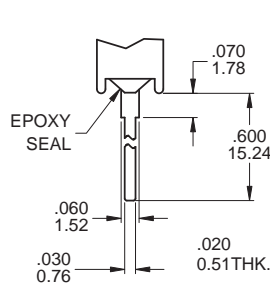

#### OTHER TERMINATION OPTIONS

- M6** Right angle P.C. Mount
- M6N** Right angle P.C. Mount with snap-in bracket
- M7** Right angle P.C. Mount
- M7N** Right angle P.C. Mount with snap-in bracket
- VS2** Right angle P.C. Mount
- V2N** Vertical bracket P.C. Mount with snap-in bracket

#### M6

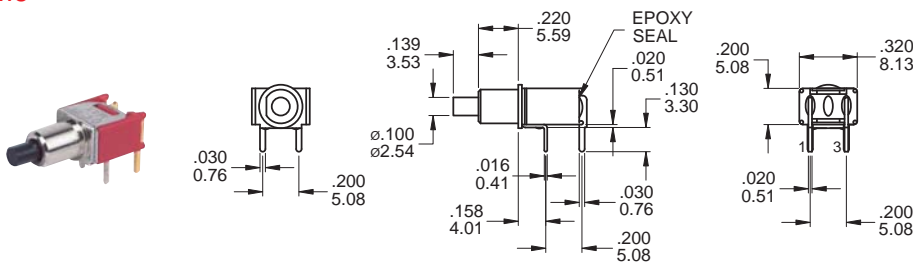

#### P.C. MOUNTING

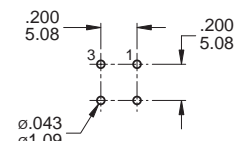

#### SPST

Part No. Shown : 8MS9P1B06M6RE

#### M6

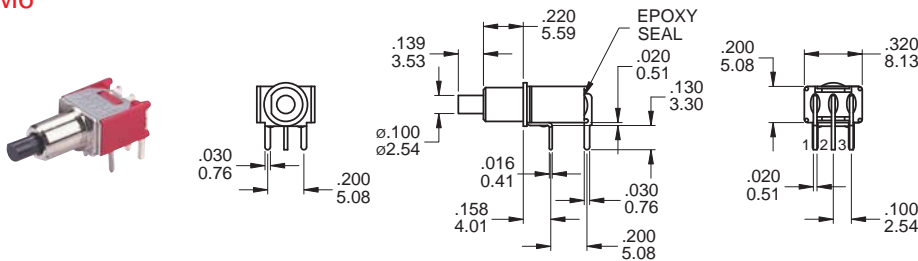

#### P.C. MOUNTING

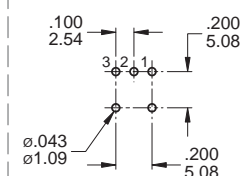

#### SPDT

Part No. Shown : 8MS8P1B06M6QE

## Sub-Miniature Pushbutton Switches

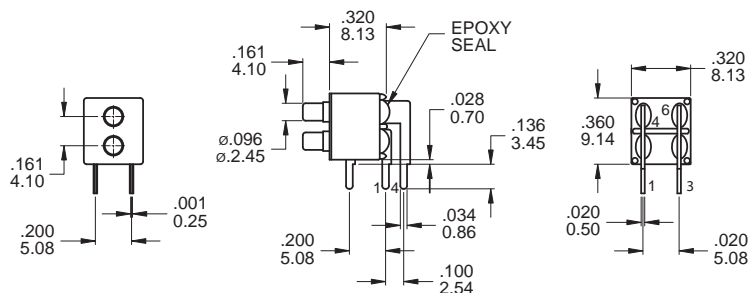

Part No. Shown : 8MD9P1B10M6RE

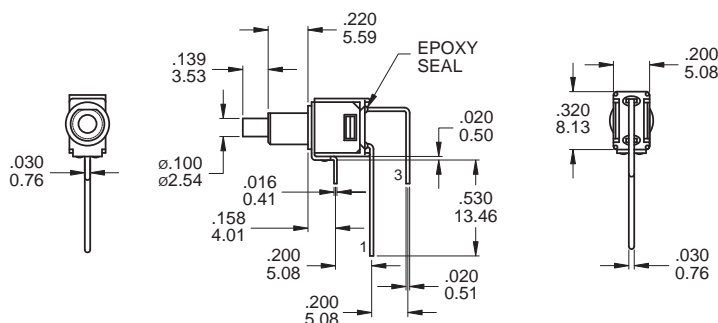

Part No. Shown : 8MS9P1B06M7QE

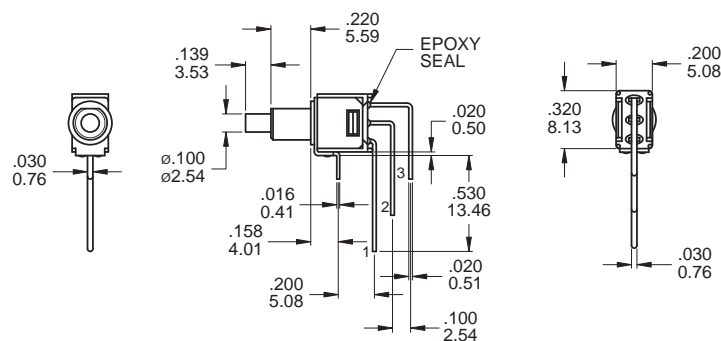

Part No. Shown : 8MS8P1B06M7QE

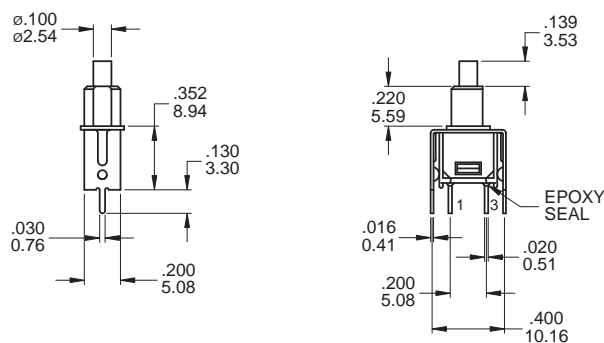
[illegible]

Part No. Shown : 8MS9P1B06VS2QE

VS2

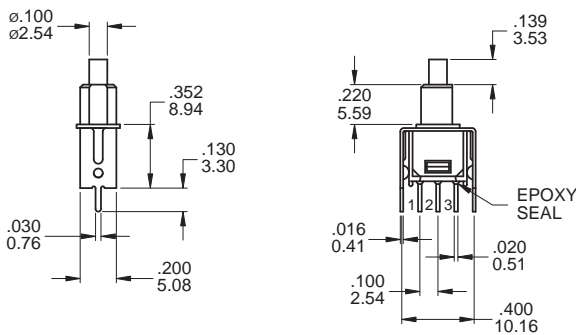

P.C. MOUNTING

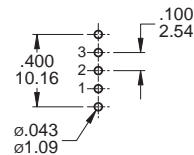

SPDT

Part No. Shown : 8MS8P1B06VS2QE

AP1

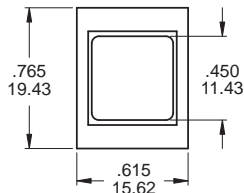

PANEL MOUNTING

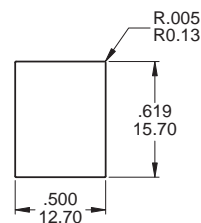

SPST

Part No. Shown : 8MS9AP122M1QE

## SNAP-IN TERMINATION OPTIONS

M6N

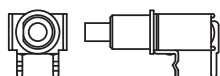

M7N

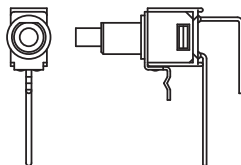

V2N

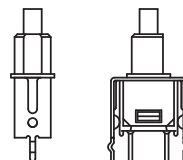

## CAP OPTIONS

C1 For 8M Series ONLY

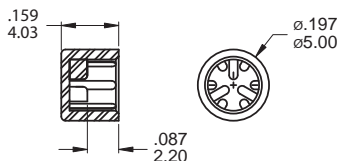

C2 For 8A,8B Series ONLY

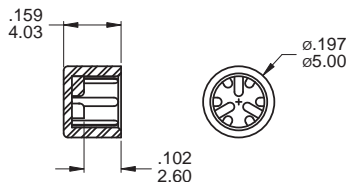

C3 For 8M Series B8,B9 Bushing ONLY

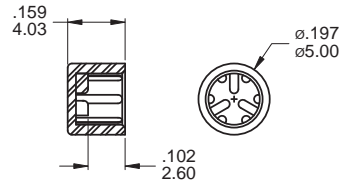

C4 For 8M Series ONLY

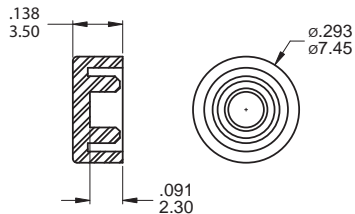

C5 For 8A,8B Series ONLY

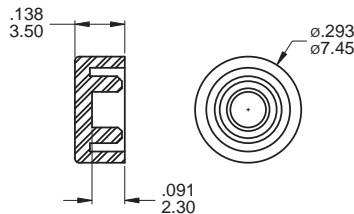

Cap Standard Color : White, Black, Red, Green

