

X2-MRA Series

Rocker Switches



MATERIALS

Housing: PA66
Rocker: PA66
Contacts: Silver alloy
Terminal: Brass silver plated
Spring: SWC
Movable arm: Brass silver plated

SPECIFICATIONS

Electrical rating : 3A 250VAC &3A 125VAC
Contact resistance: <20mΩ(initial)
Insulation resistance: > 1000MΩ(500VDC between open contacts)
Dielectric strength: > 1500V 1 minute
Mechanical life: >30000 cycles
Electrical life: >10000 cycles
Temperature rise at the terminal: Max.30℃
Solder ability of terminal: Max350℃,3S(no pressure may be placed in the terminals when soldering by hand)
Any Cd Pb Hg etc and it's compounds is not include in this product
Ambient temperature: 10T85/55
Ambient humidity: Max.85%
Degree of protection: IP20
Applicability for appliance of class: class II
Proof tracking resistance index(PTI): 175
Degree of pollution: normal



HOW TO ORDER

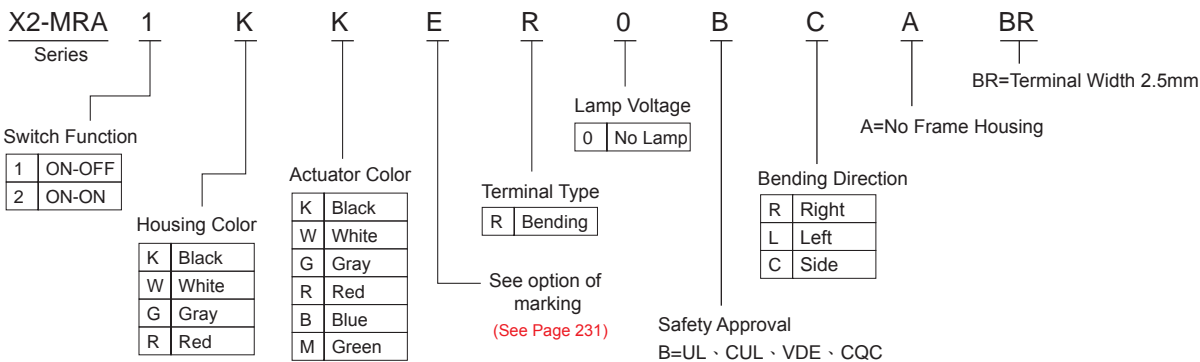
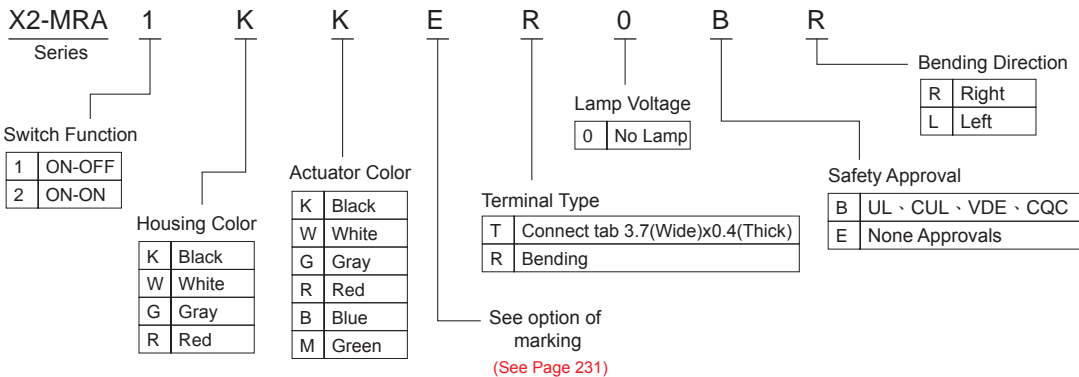

OPTIONS OF SWITCH FUNCTION

Item NO	POLES &THROWS	Rocker position		
		Left	Center	Right
X2-MRA1	SPST	ON	None	OFF
X2-MRA2	SPDT	ON	None	ON

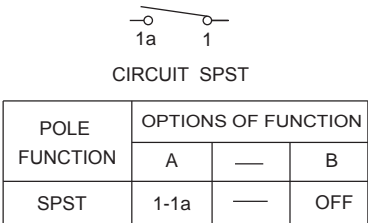

Part No. Shown :
MRA1KKETB

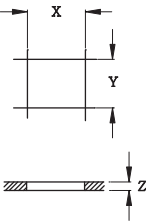
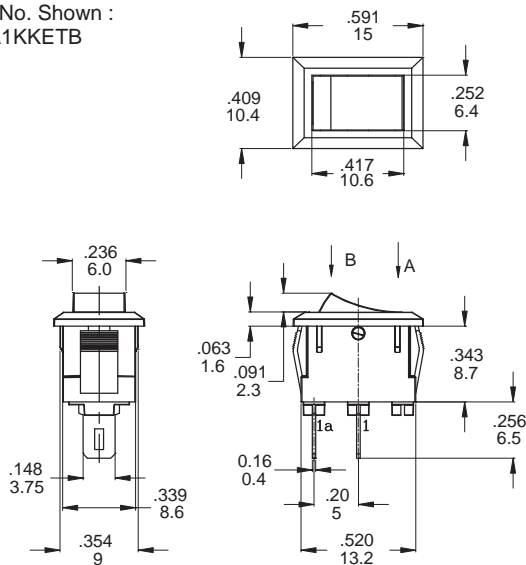

PANEL OUT-CUT		
Z	Y	X
0.7~1.25 [.028~.049]	9.1~9.2 [.358~.362]	13.6~13.8 [.535~.543]
1.25~2.0 [.049~.079]	9.1~9.2 [.358~.362]	13.8~14.0 [.543~.551]
2.0~3.0 [.079~.118]	9.1~9.2 [.358~.362]	14.0~14.1 [.551~.555]

* We keep the right to alter the dimension without notice.

Part No. Shown :
MRA1KKFR0BL

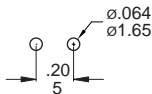
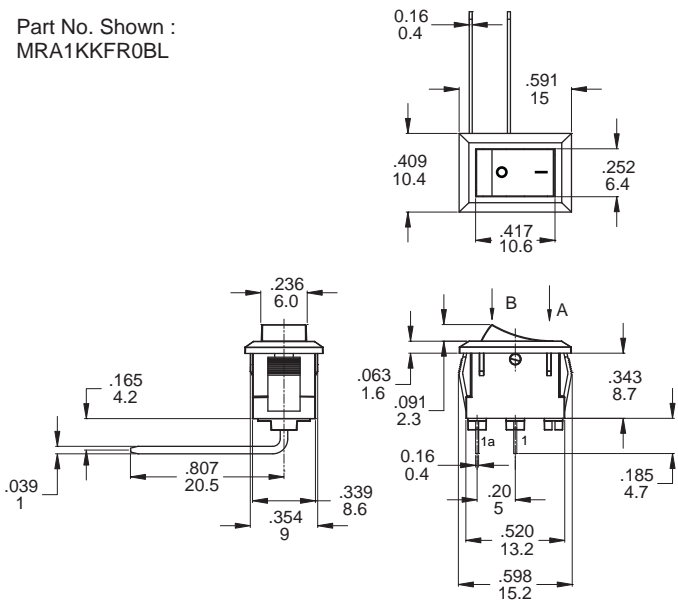

PC MOUNTING

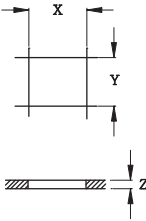

PANEL OUT-CUT		
Z	Y	X
0.7~1.25 [.028~.049]	9.1~9.2 [.358~.362]	13.6~13.8 [.535~.543]
1.25~2.0 [.049~.079]	9.1~9.2 [.358~.362]	13.8~14.0 [.543~.551]
2.0~3.0 [.079~.118]	9.1~9.2 [.358~.362]	14.0~14.1 [.551~.555]

* We keep the right to alter the dimension without notice.

X2-MRA
Rocker Switches

Part No. Shown :
MRA1KKFR0BCA-BR

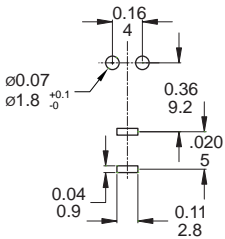
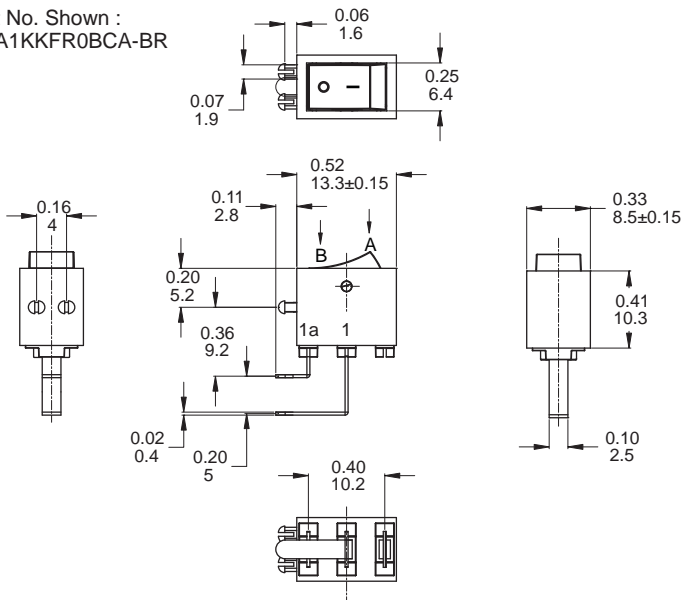

P.C MOUNTING

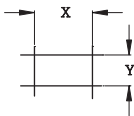

PANEL OUT-CUT	
Y	X
8.7~8.9 [.338~.354]	13.5~13.7 [.528~.543]

* We keep the right to alter the dimension without notice.