

# X2-R4 Series

Rocker Switches



## SPECIFICATION

Electrical Rating : 20A 125VAC/16A 250VAC(UL)  
16A 250VAC(VDE)  
Mechanical life: Over 30000 cycles  
Electrical life: Over 10000 cycles  
Contact resistance: <20mΩ  
Insulation resistance: >1000MΩ  
High voltage resistance: >1500V 1 min.  
Ambient temperature: Terminal side -20 to +85°C  
Actuating side -20 to +55°C  
Storage temperature: -30 to +80°C Max  
Atmospheric humidity: Max.85%  
Actuating force: 4~8N(depends on different switch function)  
Flammability: UL94 V-2  
Temperature rise at the terminal: Max 30°C (UL1054)  
Solder ability of terminal: Max 350°C, 3s

## MATERIALS

Housing: Nylon 66  
Rocker: PC & PA66  
Contacts: Silver Alloy  
Terminal: Brass Silver Plated  
Lamp: Neon Lamp, Tungsten Lamp  
Spring: SWP, SUS  
Movable Arm: Brass Silver Plated



## HOW TO ORDER

X2-R4 1 5 K K E T 0 F A

Series Switch Function Rating Housing Color Actuator Color Marking Terminal Type Lamp Voltage Safety Approval

Series	
1	ON-OFF
2	ON-ON
3	ON-OFF-ON
4	ON-(ON)
5	OFF-(ON)
6	(ON)-OFF-(ON)
7	ON-(OFF)
8	ON-OFF-(ON)

G	Gray
W	White
K	Black

See option of marking (See Page 231)	
---	--

0	Without Lamp
1	125V AC
2	250V AC
3	12 VDC
4	24 VDC

G	Gray
W	White
K	Black
O	Orange
R	Red

Quick Connect Tab	
-------------------	--

F	4 Safety Approvals
E	None Approval

5	15A 250VAC 20A 125VAC
---	--------------------------

OPTIONS OF SWITCH FUNCTION / DIMENSION

Item NO	POLES &THROWS	Rocker position ( ):Momentary		
		Left	Center	Right
X2-R41	SPST	ON	None	OFF
X2-R42	SPDT	ON	None	ON
X2-R43	SPDT	ON	OFF	ON
X2-R44	SPDT	ON	None	(ON)
X2-R45	SPST	OFF	None	(ON)
X2-R46	SPDT	(ON)	OFF	(ON)
X2-R47	SPST	ON	None	(OFF)
X2-R48	SPDT	ON	OFF	(ON)
X2-R49	SPST (WITHLAMP)	ON	None	OFF

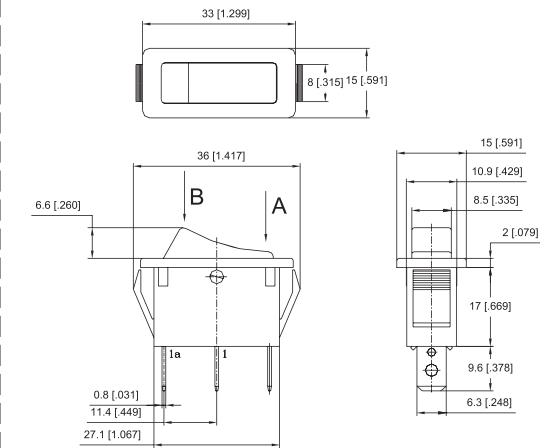

PANEL CUT OUT

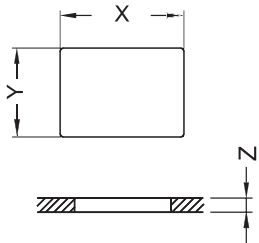

Z	Y	X
0.70~1.25	11.10~11.20	29.60~29.70
1.25~2.00	11.10~11.20	30.10~30.20
2.00~3.00	11.10~11.20	30.45~30.55

CIRCUITS FOR SWITCH WITH LAMP

For circuit of 250V AC or 125V AC  
For circuit of 24V DC or 12V DC

