

# X2-R5 Series

Rocker Switches



## SPECIFICATION

Electrical Rating : 20A 125VAC/16A 250VAC(UL)  
16A 250VAC(VDE)  
Mechanical life: Over 30000 cycles  
Electrical life: Over 10000 cycles  
Contact resistance: <20mΩ  
Insulation resistance: >1000MΩ  
High voltage resistance: >1500V 1 min.  
Ambient temperature: Terminal side -20 to +85°C  
Actuating side -20 to +55°C  
Storage temperature: -30 to +80°C Max  
Atmospheric humidity: Max.85%  
Actuating force: 4~8N(depends on different switch function)  
Flammability: UL94 V-2  
Temperature rise at the terminal: Max 30°C (UL1054)  
Solder ability of terminal: Max 350°C ,3s

## MATERIALS

Housing: Nylon 66  
Rocker: PC & PA66  
Contacts: Silver Alloy  
Terminal: Brass Silver Plated  
Lamp: Neon Lamp,Tungsten Lamp  
Spring: SWP,SUS  
Movable Arm: Brass Silver Plated



## HOW TO ORDER

X2-R5 1 5 K K E T 0 F A

Series	Switch Function	Rating	Housing Color	Actuator Color	Marking	Terminal Type	Lamp Voltage	Safety Approval		
Series			W	White	See option of marking (See Page 231)		0	Without Lamp		
			K	Black			1	125V AC		
1	ON-OFF	5	W	White	Y	Yellow(III.)	2	250V AC	F	4 Safety Approvals
2	ON-ON						3	12 VDC		
3	ON-OFF-ON						4	24 VDC		
4	ON-(ON)		K	Black	M	Green(III.)	E	None Approval		
5	OFF-(ON)		R	Red	D	Red(III.)				
6	(ON)-OFF-(ON)				F	Blue(III.)				
7	ON-(OFF)		Quick Connect Tab							
8	ON-OFF-(ON)									
9	ON-OFF (With Lamp)									

X2-R5  
Rocker Switches

OPTIONS OF SWITCH FUNCTION / DIMENSION

Item NO	POLES &THROWS	Rocker position ( ):Momentary		
		Left	Center	Right
X2-R51	DPST	ON	None	OFF
X2-R52	DPDT	ON	None	ON
X2-R53	DPDT	ON	OFF	ON
X2-R54	DPDT	ON	None	(ON)
X2-R55	DPST	OFF	None	(ON)
X2-R56	DPDT	(ON)	OFF	(ON)
X2-R57	DPST	ON	None	(OFF)
X2-R58	DPDT	ON	OFF	(ON)
X2-R59	DPST (WITHLAMP)	ON	None	OFF

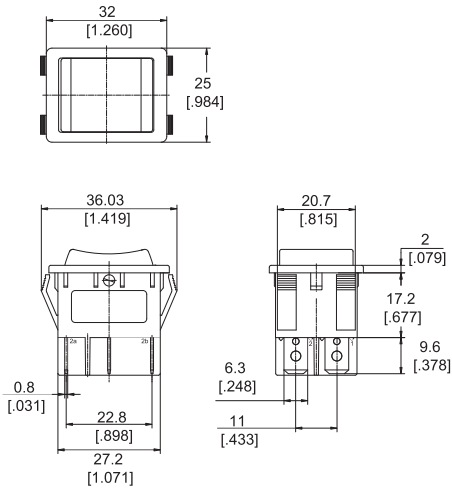

PANEL CUT OUT

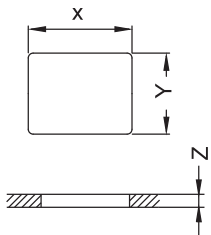

Z	Y	X
0.70~1.25	22.20~22.30	30.0~30.20
1.25~2.00	22.20~22.30	30.2~30.40
2.00~3.00	22.20~22.30	30.6~30.80

CIRCUITS FOR SWITCH WITH LAMP

For circuit of 250V AC or 125V AC  
For circuit of 24V DC or 12V DC

