

DIP TYPE

# STP 1250

STP 1250

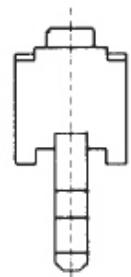
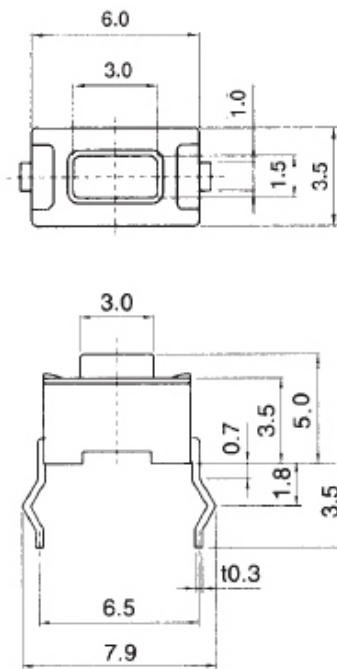

- 1. Rating 工作电流, 电压 : DC 12V, 50mA
- 2. Travel 移动 :  $0.25 \pm \begin{smallmatrix} 0.2 \\ 0.1 \end{smallmatrix}$  m/m
- 3. Contact Resistance 接触电阻 : 100m  $\Omega$  Max.
- 4. Life Cycle 使用寿命 : 50,000 Cycles

Model No.	Operating Force	Case Color
STP 1250	180 $\pm$ 30gf	Black
STP 1250W	260 $\pm$ 50gf	White