

SMD TYPE

STP-1112E

STP 1112, STP 1112E

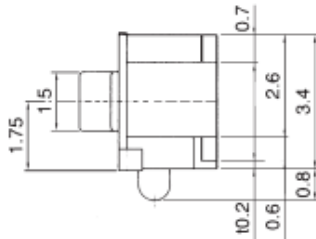
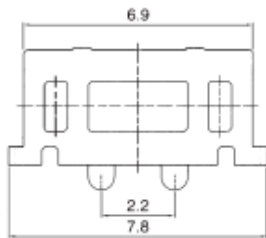

(STP 1112E)

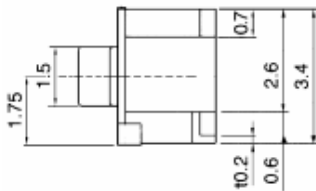
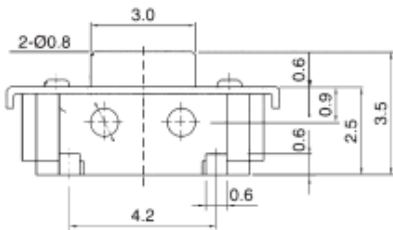

(STP 1112)

- 1. Rating 工作电流, 电压 : DC 12V, 50mA
- 2. Travel 移动 : 0.25mm
- 3. Contact Resistance 接触电阻 : 100mΩ Max.
- 4. Life Cycle 使用寿命 : 50,000 Cycles
- 5. Reel Package : 2,000PCS/REEL

Model No.	Operating Force	Stem Color
STP 1112, STP 1112E	180gf	Black
STP 1112S, STP 1112ES	260gf	Red