

LED TYPE

STP-1193

STP 1193

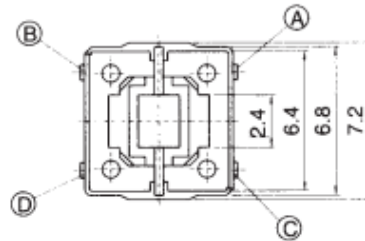
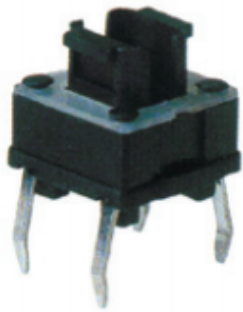

CIRCUIT DIAGRAM

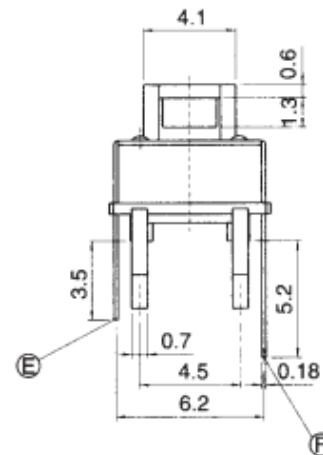
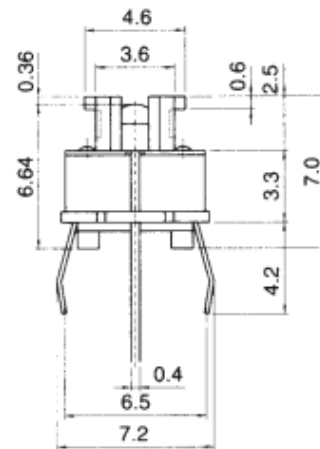
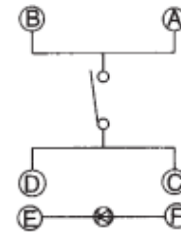

1. Rating 工作电流, 电压 : DC 12V, 50mA
2. Travel 移动 : 0.25 ± 0.2 m/m
3. Operating Force 操作力 : 160 ± 30 gf
4. Contact Resistance 接触电阻 : $100\text{m}\Omega$ Max.
5. Life Cycle 使用寿命 : 100,000 Cycles
6. With Led : Option

Model No.	Color (Led)
STP 1193R	Red
STP 1193G	Green
STP 1193Y	Yellow