

CR36 series outside the US  
and the UK.

# P36 series

Low profile rotary code switches

Surface mount or through-hole



- ☐ 3 actuator types
- ☐ Save board space
- ☐ Highly reliable
- ☐ Solder and flux sealed, washable

UG1006-A

P36				
<b>SERIES</b>	<b>Mounting</b>	<b>Actuators</b>	<b>Codes</b>	<b>Terminals</b>
	(none) Through-hole S Surface mount	1 Screwdriver 3 Spindle 8 Slotted spindle	01 BCD 02 BCD complement 03 Hexadecimal 06 Hexadec. complement	(none) Straight or SMT V Crimped L254 Right angle, spacing 2,54 (.100)

## ELECTRICAL SPECIFICATIONS

- Operating voltage : 24 VDC max.
- Contact load, static : 400mA max.
- Contact load, dynamic : 100mA max.
- Initial contact resistance : 100 mΩ max.
- Insulation resistance : 100 MΩ min.

## MECHANICAL AND THERMAL SPECS

- Torque : 0,7 Ncm min.
- Expected life : 10.000 cycles min.
- Operating temperature : -30°C to +90°C

## MATERIALS

- Base : UL94-V0, high temperature thermoplastic
- Cover : stainless steel
- Actuator : PA 4,6 nylon
- Contacts : gold over nickel plated phosphor bronze
- Terminals : tin plated

## SOLDER RECOMMENDATIONS

(DIN CEI 68-2-20)

- Manual soldering : 340°C max. for 2 seconds max.
- Wave soldering : 280°C max. for 5 seconds max.
- Reflow soldering : 260°C max. for 10 seconds max.

## PACKAGING

**P36S1..**  
1300 pieces per reel  
(dim.A = 22,4 mm  
dim B = 16,4 mm)

**P36S3..**  
**P36S8..**  
600 pieces per reel  
(dim.A = 30,4 mm  
dim B = 24,4 mm)

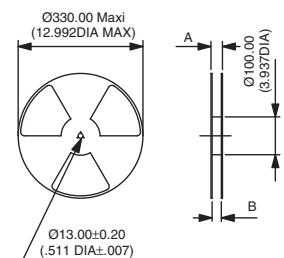
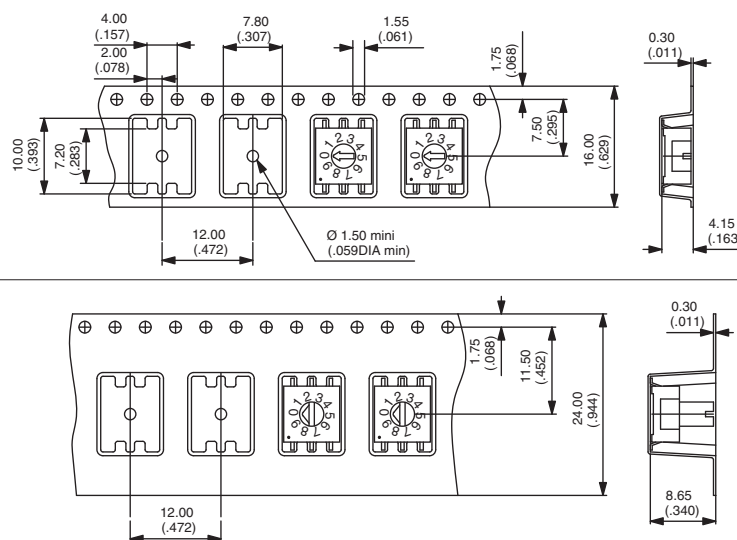

- Reels : see above. To order a SMT product with tape & reel packaging, add "TR" at the end of its part number.
- Tubes : 50 pieces (through-hole or SMT) per tube.

**Dimensions** : first dimensions are in mm while inches are shown as bracketted numbers.

# P36 series

## Low profile rotary code switches

Surface mount or through-hole

### MOUNTING

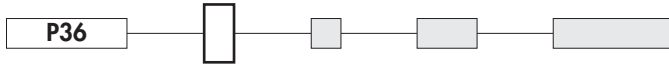

#### (none) Through-hole

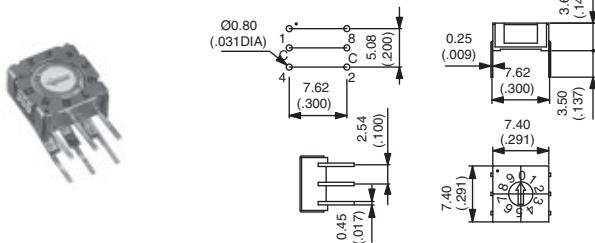

#### S Surface mount

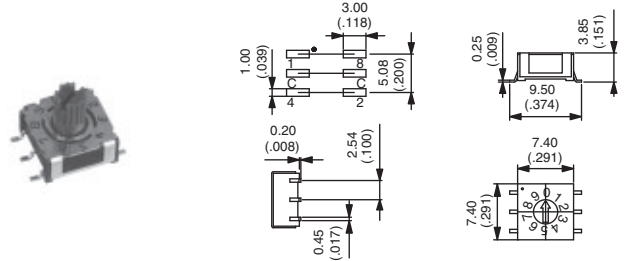

### ACTUATORS

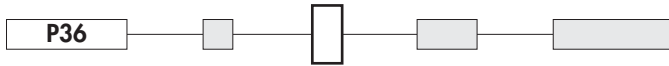

#### 1 Screwdriver

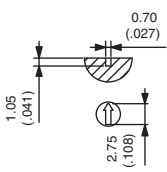

#### 3 Spindle

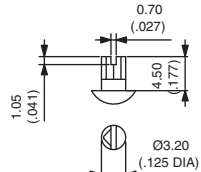

#### 8 Slotted spindle

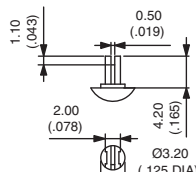

Actuator colour depending on codes

BCD red  
BCD compl. orange  
Hexadecimal grey  
Hexadec. compl. white

### CODES / TRUTH TABLES

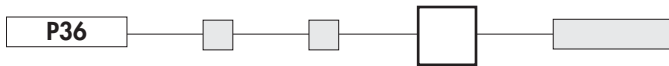

01 BCD					
	C	1	2	4	8
0	●				0
1	●	●			1
2	●		●		2
3	●	●	●		3
4	●			●	4
5	●	●		●	5
6	●		●	●	6
7	●	●	●	●	7
8	●				8
9	●	●			9

▲ Position ▲ Marking

02 BCD complement					
	C	1	2	4	8
0	●	●	●	●	0
1	●	●	●	●	1
2	●	●	●	●	2
3	●	●	●	●	3
4	●	●	●	●	4
5	●	●	●	●	5
6	●	●	●	●	6
7	●	●	●	●	7
8	●	●	●	●	8
9	●	●	●	●	9

03 Hexadecimal					
	C	1	2	4	8
0	●				0
1	●	●			1
2	●		●		2
3	●	●	●		3
4	●			●	4
5	●	●		●	5
6	●		●	●	6
7	●	●	●	●	7
8	●				8
9	●	●			9
10	●		●		A
11	●	●		●	B
12	●			●	C
13	●	●	●	●	D
14	●		●	●	E
15	●	●	●	●	F

06 Hexadecimal complement					
	C	1	2	4	8
0	●	●	●	●	0
1	●	●	●	●	1
2	●	●	●	●	2
3	●	●	●	●	3
4	●	●	●	●	4
5	●	●	●	●	5
6	●	●	●	●	6
7	●	●	●	●	7
8	●	●	●	●	8
9	●	●	●	●	9
10	●	●	●	●	A
11	●	●	●	●	B
12	●	●	●	●	C
13	●	●	●	●	D
14	●	●	●	●	E
15	●	●	●	●	F

### TERMINALS

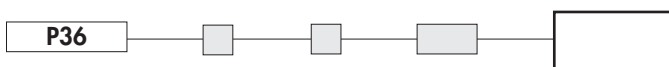

#### (none) Straight or SMT



#### V Crimped

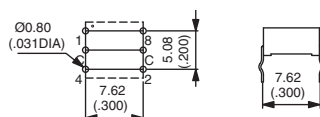

#### L254 Right angle, spacing 2,54 (.100)

