



SPECIFICATIONS

CONTACT RATING: Max. 0.4 VA max. @ 48 VAC or DC

MECHANICAL LIFE: minimum 40,000 operations.

CONTACT RESISTANCE: 50 mΩ max.

INSULATION RESISTANCE: 1,000 MΩ min./500VDC

DIELECTRIC STRENGTH: 500 Vrms min.@sea level.(initial value)

OPERATING TEMPERATURE: -20°C to 85°C.

MATERIALS

ACTUATOR: Brass with chrome plated, internal o-ring sealed.

BUSHING & HOUSING: SPCC

CASE: Glass filled nylon 6/6, flame retardant, heat stabilized
(UL94v-0)

SWITCH SUPPORT: Brass, tin plated.

CONTACT: Phosphor bronze gold plated over nickel barrier.

TERMINALS: Brass, gold plated.

TERMINAL SEAL: Epoxy









HOW TO ORDER

MODEL NO.	TERMINAL TYPE	TERMINAL PLATING	SEAL	RoHS SOLDERING
SP		R Gold	E EPOXY (std)	S RoHS & Lead Free
TGS07-S1 ON-NONE-ON				
TGS07-S2 ON-NONE-(ON)				
TGS07-S3 ON-OFF-ON				
TGS07-S4 (ON)-OFF-(ON)	M2 PC thru-hole			
TGS07-S5 ON-OFF-(ON)	M6 Right angle, PC thru-hole			
TGS07-S9 OFF-NONE-ON	M7 Vertical right angle, PC thru-hole			
DP				
TGS07-D1 ON-NONE-ON				
TGS07-D2 ON-NONE-(ON)				
TGS07-D3 ON-OFF-ON				
TGS07-D4 (ON)-OFF-(ON)				
TGS07-D5 ON-OFF-(ON)				

EXAMPLE: TGS07-S1M2RES

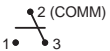
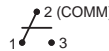
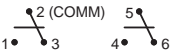

▼ SWITCH FUNCTION

NO. POLES	MODEL NO.	SWITCH FUNCTION			CONNECTED TERMINALS / SCHEMATIC		
		POS.1	POS.2	POS.3	POS.1	POS.2	POS.3
							
SP	TGS07-S1	ON	NONE	ON	<div>2-3</div> 	N/A	<div>2-1</div> 
	TGS07-S2	ON	NONE	(ON)		OPEN	
	TGS07-S3	ON	OFF	ON			
	TGS07-S4	(ON)	OFF	(ON)			
	TGS07-S5	ON	OFF	(ON)			
	TGS07-S9	OFF	NONE	ON	OPEN	N/A	2-1
DP	TGS07-D1	ON	NONE	ON	<div>2-3,5-6</div> 	N/A	<div>2-1,5-4</div> 
	TGS07-D2	ON	NONE	(ON)		OPEN	
	TGS07-D3	ON	OFF	ON			
	TGS07-D4	(ON)	OFF	(ON)			
	TGS07-D5	ON	OFF	(ON)			

()=MOMENTARY

* Omit terminal 3

▼ POLE OPTIONS

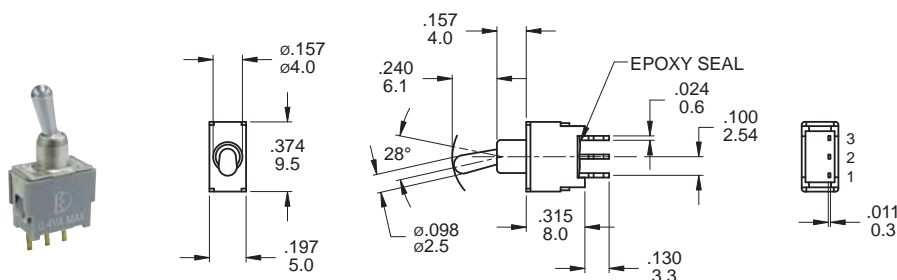

SPDT

Model name. TGS07-S1M2RES

PCB MOUNTING

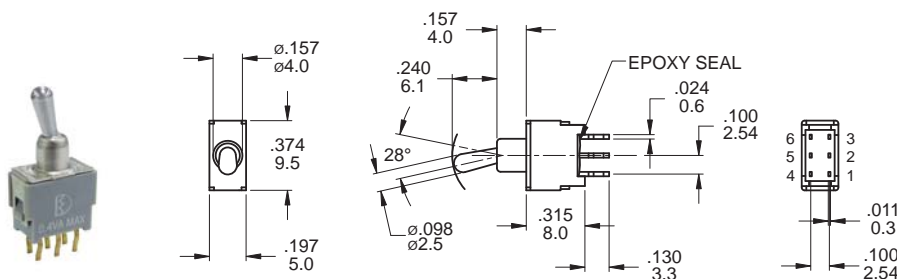
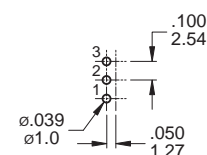

DPDT

Model name. TGS07-D1M2RES

PCB MOUNTING

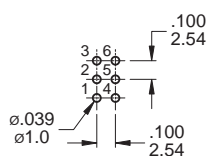



▼ TERMINAL OPTIONS

M6

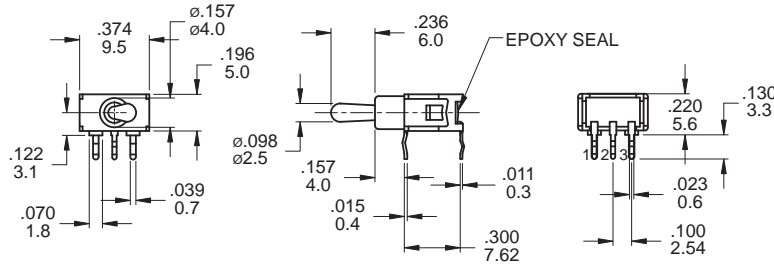

PCB MOUNTING

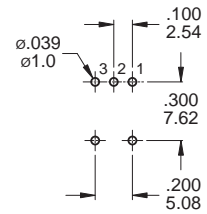

SPDT

Model name. TGS07-S1M6RES

M6

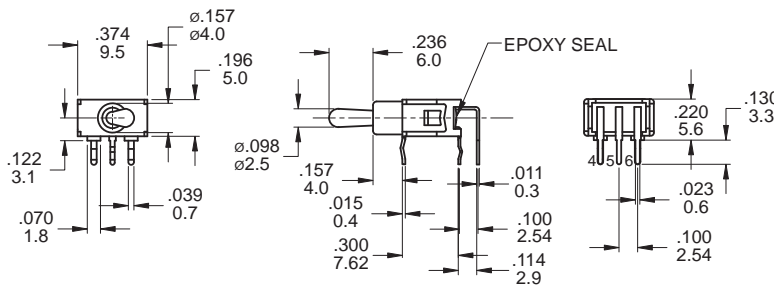

PCB MOUNTING

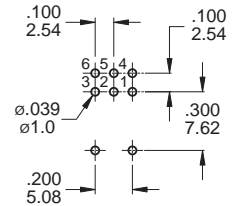

DPDT

Model name. TGS07-D1M6RES

M7

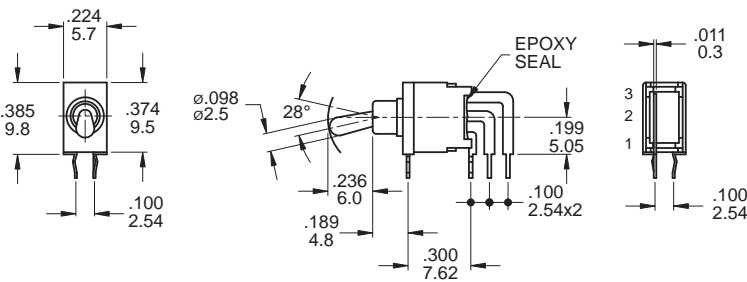

PCB MOUNTING

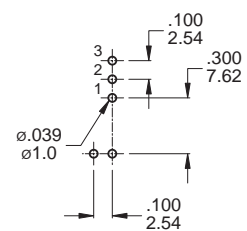

SPDT

Model name. TGS07-S1M7RES

M7

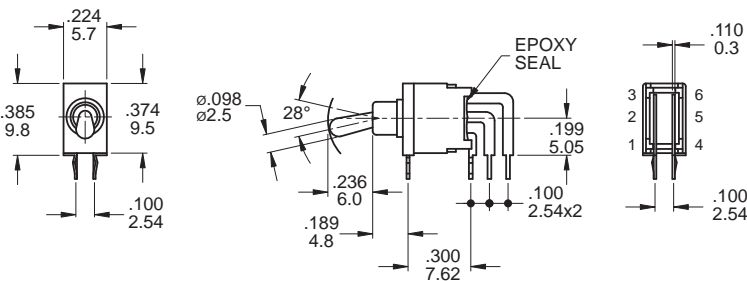

PCB MOUNTING

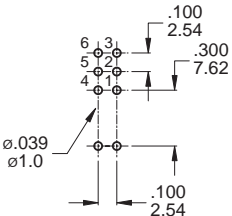

DPDT

Model name. TGS07-D1M7RES

▼ SOLDERING PROCESS

WAVE SOLDERING: Recommend soldering temperature: $260 \pm 5^{\circ}\text{C}$

Duration of solder immersion: Max 5 sec. (PCB thickness is 1.6mm)