



# RS08 Series

## ROTARY DIP SWITCH 10x10 Size, Height: 4.5mm, 3x3 Terminal



**RS08**  
Series

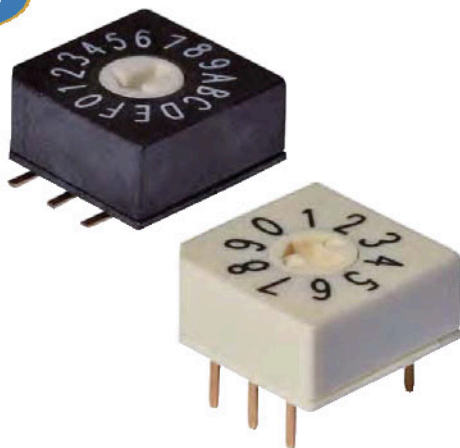

### General Specification

- Rating :** 25mA, 12V DC (Switching)  
25mA, 24V DC (None-Switching)
- Contact Resistance :** 100mΩ Max.
- Insulation Resistance :** 100MΩ Min at DC 250V
- Operating Force :** 700gf Max.
- Life Cycle :** 10,000 steps
- Sealing :** IP67 (Dust & Water proof)

### GENERAL DIMENSION

#### Through Hole Type Layout

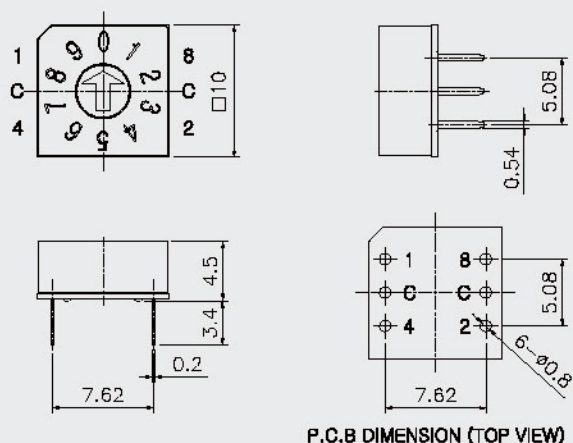

#### SMD Gull Wing Type Layout

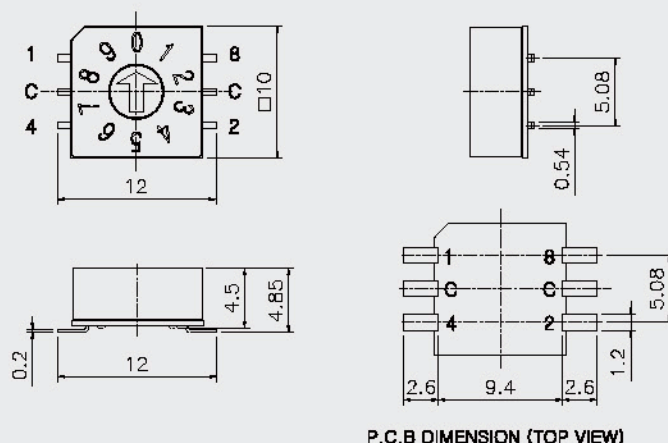

### HOW TO ORDER

**RS08**
**D**
**R**
**10**
**S**
**TR**

#### Cover Type

RS08 Square (Ter' 3x3)  
Position of  
Number 0 = 0°  
RS08A Square (Ter' 3x3)  
Position of  
Number 0 = -90°

#### Actuator

D Arrow  
(Height = 0mm)

#### Code

R Real Code  
C Complement Code  
G Gray Code  
\*Other special codes  
are available  
upon the request.

#### Position

04 4 Position  
06 6 Position  
08 8 Position  
10 10 Position  
16 16 Position

#### Terminal

- Through-Hole  
(Ter' 3x3)  
S SMD Gull Wing  
(Ter' 3x3)

#### Packing

- Tube Packing  
TR Reel Packing

# ROTARY DIP SWITCH 10x10 Size, Height: 4.5mm, 3x3 Terminal

## 1. Cover Type

RS08

RS08 Type

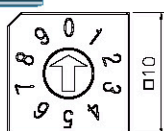

U Type

Position of printed No.0 (0°)

RS08A Type

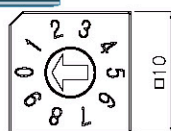

UA Type

Position of printed NO.0 (-90°)

## 2. Actuator

D

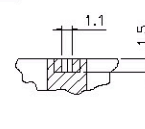
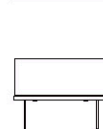
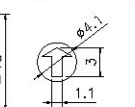
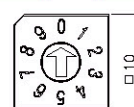
Arrow  
(Height = 0mm)

## 3. Code & Position

R RealCode



04 POSITION



06/08/10/16 POSITION

C ComplementCode



04 POSITION



06/08/10/16 POSITION

G Gray Code



10 POSITION



10/16 POSITION



16 POSITION



16 POSITION

\* See page 25 for special codes.

## 4. Terminal

Through-Hole (Ter' 3x3)

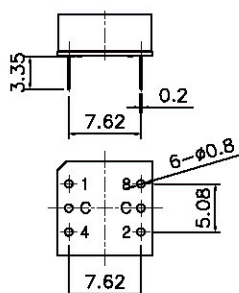

P.C.B DIMENSION (TOP VIEW)

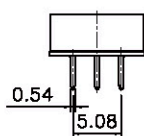

SMD Type (Ter' 3x3)

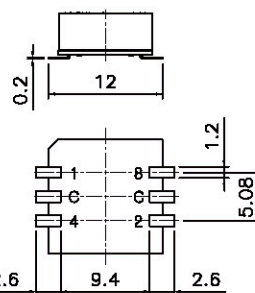

P.C.B DIMENSION (TOP VIEW)

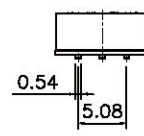

## 5. Packing

Tube Packing (Q'ty: 50Pcs/Tube)

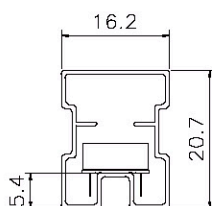

Through-Hole Type

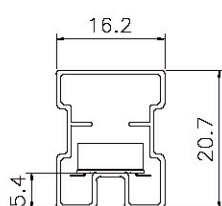

SMD Type

TR

Reel Packing  
(See Page 29)

# ROTARY DIP SWITCH 10x10 Size Tape & Reel Packing

## 1. 'D' Type Actuator with SMD Terminal

(RS08-DR-xxS)

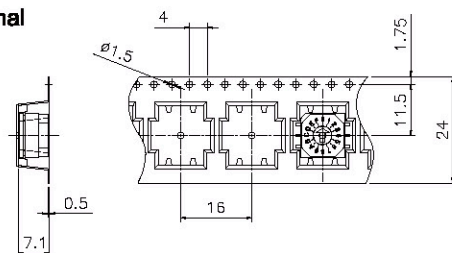

Units(pcs)

600

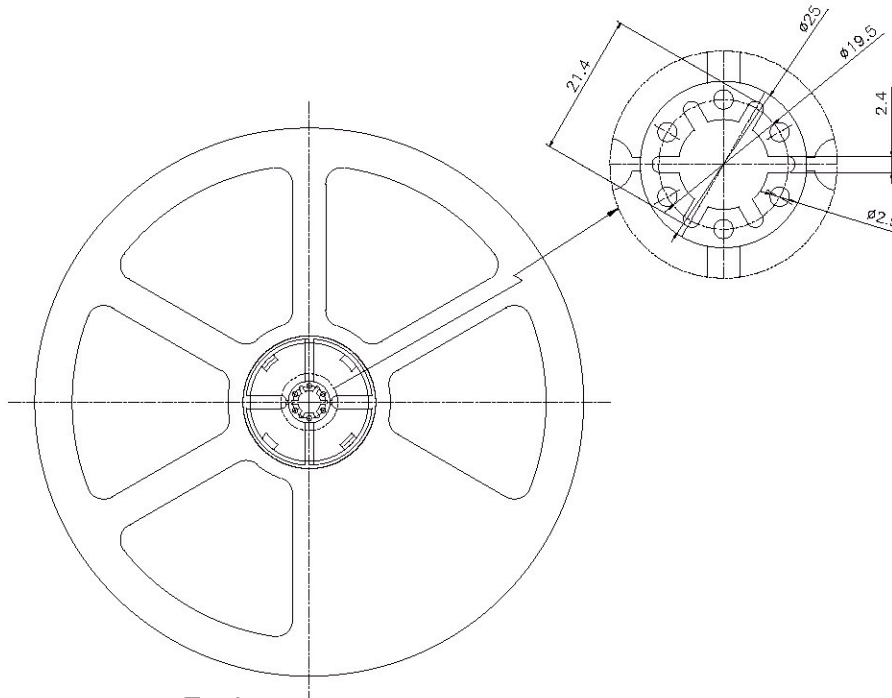
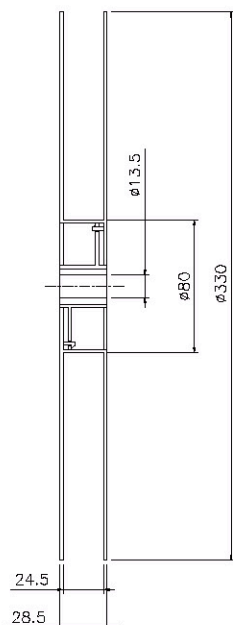

End

Start

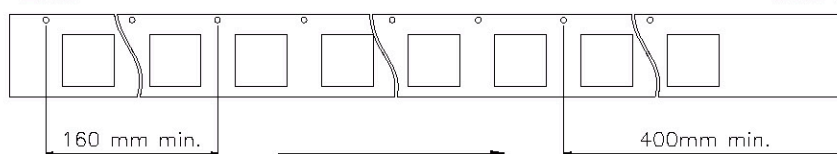

End Section

Direction of Section

Advance