

FEATURE

1. Sealed construction
2. Ultraminiature size
3. High temperature materials (UL 94V-0)

SPECIFICATIONS

CONTACT RATING: max 0.4 VA max @ 28 VDC

Min . 1 μ A /20 mVDC

LIFE CYCLE: 10,000 make-and-break cycles

CONTACT RESISTANCE: 100 m Ω max. initial @2-4 VDC, 100 mAINSULATION RESISTANCE: 500 M Ω min.

DIELECTRIC STRENGTH: 250 VAC, 50 Hz for the duration of 1 minute.

OPERATING TEMPERATURE: -20°C to +85°C

M1



MATERIALS

CASE - nylon 4/6

ACTUATOR - nylon

BASE - nylon 4/6

TERMINAL - Copper alloy, gold-plated or tin plated

CONTACT - Copper alloy, silver plated

LOOP SEALING - rubber

How do you modify the switches you need!!

U T - 4 - T 2 C K - 2 - -

Switches Function		Actuator		Termination		Contact Material		Actuator color		Case color	
UT-4	SP on-none-on	T2	3.80	C	PC (straight type)	R	gold plated (std.)	1	white		: white (std.)
UT-4A	SP on-off-on			S	PC (snap-in type)	K	gold / tin plated	2	black	2	: black
UT-5	DP on-none-on			H	horizon						
UT-5A	DP on-off-on			V	vertical						
				M	SMT						
				M1	SMT						
										RoHS code	
										H = RoHS Compliant	



SPDT 1 2 Comm 3

Model No.	Switching position		
UT-4	ON	none	ON
UT-4A	ON	OFF	ON
Term. Comm.	2-3	open	2-1

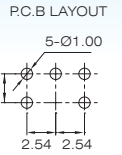
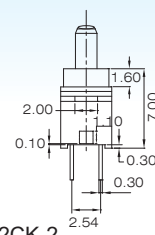
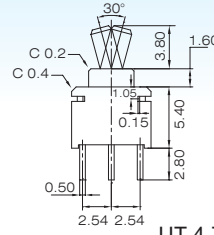
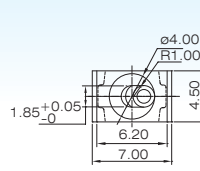

UT-4-T2CK-2

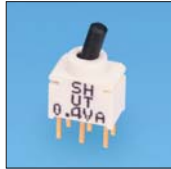

DPDT 1 2 Comm 3 4 5 Comm 6

Model No.	Switching position		
UT-5	ON	none	ON
UT-5A	ON	OFF	ON
Term. Comm.	2-3,5-6	open	2-1,5-4

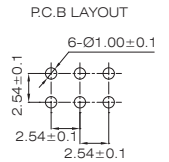
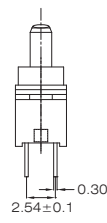
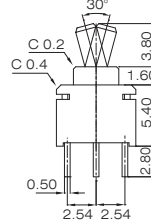
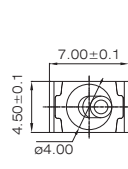

UT-5-T2CK-2



SPDT 1 2 Comm 3

Model No.	Switching position		
UT-4	ON	none	ON
UT-4A	ON	OFF	ON
Term. Comm.	2-3	open	2-1

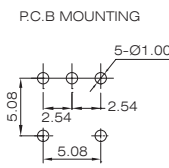
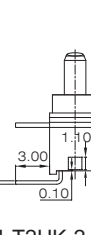
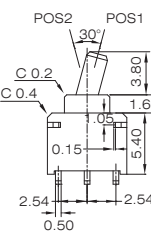
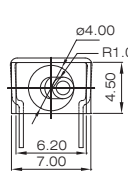

UT-4-T2HK-2



DPDT 1 2 Comm 3 4 5 Comm 6

Model No.	Switching position		
UT-5	ON	none	ON
UT-5A	ON	OFF	ON
Term. Comm.	2-3,5-6	open	2-1,5-4

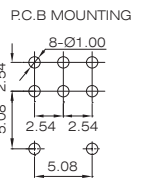
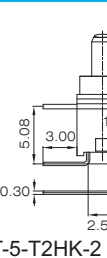
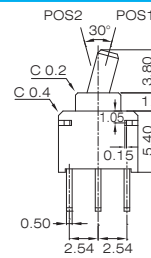
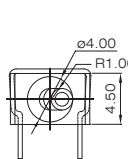

UT-5-T2HK-2



SPDT 1 2 Comm 3

Model No.	Switching position		
UT-4	ON	none	ON
UT-4A	ON	OFF	ON
Term. Comm.	2-3	open	2-1

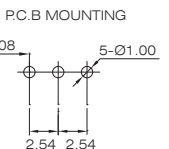
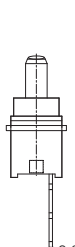
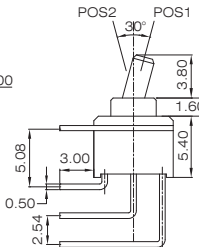
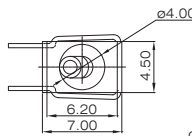

UT-4-T2VK-2



DPDT 1 2 Comm 3 4 5 Comm 6

Model No.	Switching position		
UT-5	ON	none	ON
UT-5A	ON	OFF	ON
Term. Comm.	2-3,5-6	open	2-1,5-4

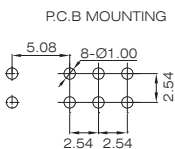
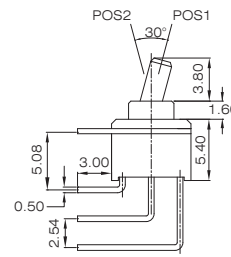
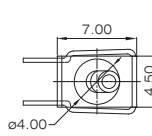

UT-5-T2VK-2



SPDT 1 2 Comm 3

Model No.	Switching position		
UT-4	ON	none	ON
UT-4A	ON	OFF	ON
Term. Comm.	2-3	open	2-1

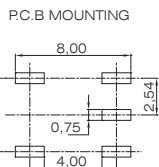
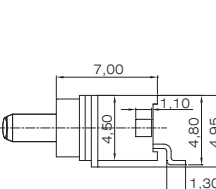
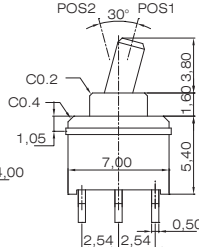
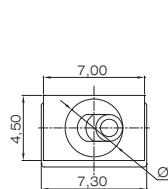

UT-4-T2MK-2