

Technical drawing of a rectangular plate. The main drawing shows a plate with a total width of 7.62 and a total height of 6.5. The plate is divided into four vertical sections by three dashed lines. A detail view of the bottom edge shows a thickness of 0.2t.

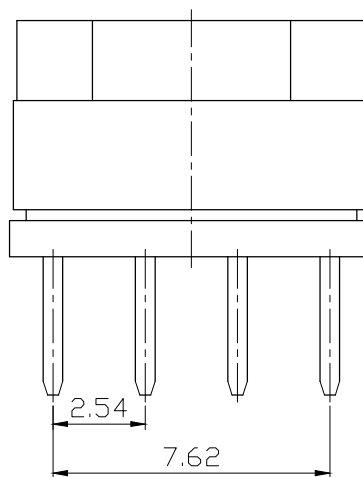

1. Rating : 150mA, 42V DC (Switching)
200mA, 42V DC (None-Switching)
2. Contact Resistance : 80mΩ Max
3. Insulation Resistance : 100MΩ Min
4. Operating Force : 700gf Max
5. Life cycle : 10,000 steps

		Real Coded		
		C	1	2
04 P o s i t i o n	0	●		
	1	●	●	
	2	●		●
	3	●	●	●

APPD	CHKD	D'SGD	TITLE. ROTARY DIP SWITCH	
K.L LEE	J.P ROH	Y.N JEON 2018.07.12	MODEL NO. FDR-04	REV 0
			SUNGUN ELECTRONICS CO., LTD.	